

OceanLED

Ocean LED Marine LTD

Unit 1 Jacknell Road
Dodwells Bridge Industrial Estate
Hinckley,
Leicestershire LE10 3BS
United Kingdom
Tel: +44 (0) 1455 637505
Fax: +44 (0) 1455 238553
sales@oceanled.com



OceanLED USA OceanLED USA LLC

778 South Military Trail
Deerfield Beach
Florida
Tel: +1 954.523.2250
Fax: +1 954.523.2249
sales@oceanledusa.com

**For full installation guide and
warranty information, go to
www.oceanled.com/sport**

or scan the QR code below:



© 2023 Ocean LED Marine LTD
All Rights Reserved

Specifications are subject to change
without notice.

Trademarks are the property of
Ocean LED Marine LTD

www.oceanled.com

OceanLED

Sport Series

Quick Install Guide

For full instructions visit
www.oceanled.com/sport



OceanLED makes every effort to protect our marine and fresh water environment as well as our natural resources. Please take care to keep packaging away from and out of the water by ensuring loose packaging materials are secured and not susceptible to being blown into the water. Please recycle all packaging materials as the sustainability of our environment is everyone's responsibility.

WARNING: Ensure mounting location is flat and check internally for ease of access or if there is a rib, strut, stringer or other hull irregularity that may interfere with the installation.

WARNING: We recommend you use screws provided. If alternative screws are used, do not use counter sunk or non flat shoulder screws to secure your lights to the hull. Never use power tools to secure your lights; **hand tighten only.**

WARNING: OceanLED recommends dry fitting all products. When installing, be sure that the light fits the area and secures to the hull using the appropriate hardware before applying any sealant.

WARNING: There are several different hull types. Most are either solid GRP or cored. Be sure you follow the correct procedures for the hull you are preparing since all require different preparation methods. We will cover the most common type below. If in doubt please contact your local OceanLED representative or the boat manufacturer for assistance.

WARNING: Please check all components and test unit/s prior to installation. If there is any damage to connectors, cables, and/or any other component, please notify OceanLED BEFORE installation. Failure to notify OceanLED of damage in transit prior to installation will lead to violation of warranty.

WARNING: Light is for mounting directly to a flat surface on the hull, with the cable passing through a 1/2" (12.5mm) hole in the hull. Do not submerge your cable in water; cable and connections exposed to underwater submersion will not be covered by warranty. Mounting the light in any other configuration, other than those described in this guide, will invalidate its warranty.

WARNING: Do not use any un-authorized cleaning products to remove excess paint or antifoul off the front face of the light unit. OceanLED recommends using Isopropyl Alcohol (IPA) only. OceanLED does not recommend that bottom paint or any type of anti-fouling agent is applied to the light body, as damage may occur due to chemical incompatibility. Never clean lights using a high-pressure jet wash; this will invalidate the warranty.

Contents

- 1 x SPORT LED Light & Cable
- 1 x In-line fuse kit
- 3 x Mounting Screws

1. Preparing a fiberglass hull

NOTE: For installation on Metal and Carbon Fibre hulls, the optional Isolating Kit must be used, please refer to instructions supplied with the kit.

Always wear safety goggles and a dust mask.

1. Drill a 3mm / 1/8" pilot hole square to mounting surface from inside the hull if possible. If there is a rib, strut, or other hull irregularity near the selected mounting location, this will need to be taken into account in the planning phase and the location adjusted accordingly, or the obstruction safely removed or modified. If the pilot hole is found to be drilled in the wrong location, drill a second hole in a better location and repair first pilot hole.
2. Using a suitable drill, make a 1/2" (12.5mm) hole. Ensure the light will fit flush and will be square to the mounting surface.
3. Sand the area around the hole using a heavy grit sandpaper to remove the previous bottom paint and to ensure that the sealant will adhere properly to the hull. If there is any petroleum residue inside the hull, remove it with acetone before sanding.
4. Place light fixture into position or use mounting template provided, ensuring light fixture is correctly orientated with logo in an upright position to maximise beam spread effect. Mark the screw hole position and pilot drill using correct sized drill bit for included screws.
5. Always dry fit units before applying any sealant.

2. Installing the light fixture

Use a suitable marine sealant such as 3M™ Marine Adhesive Sealant Fast Cure 4200FS. When applying sealant to light fixture, be careful to protect the lens from any abrasive surface/floor so as not to remove the protective Tritonium coating.

1. Test light(s) before fitting. Before proceeding with the fitting of the light(s), it is essential to test them to ensure their functionality.
2. Apply a generous amount of the chosen sealant to the back perimeter of the light body. Ensure that the cable of the light is thoroughly coated where it meets the back of the light. There should be a continuous and unbroken bead of sealant around the perimeter of the light unit, including the screw holes and cable exit.

When applying sealant to light fixture, be careful to protect the lens from any abrasive surface/floor so as not to remove the protective Tritonium coating

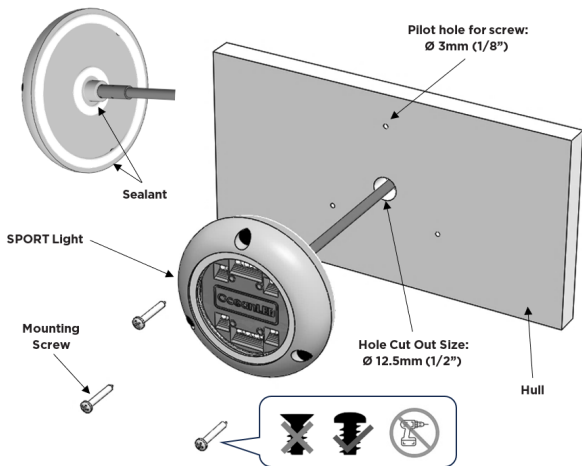

3. Insert the light on to the hull, feeding the cable through first, and then seat into place. Press the light firmly onto the hull to ensure a secure and adhesive attachment.
4. To ensure correct dispersion of light underwater, ensure all Sport Lights are mounted with the correct orientation with the logo text facing upwards.
5. Cover the screw threads with the sealant and screw into the pre-drilled pilot holes.

WARNING: Tighten the screws with a hand tool ONLY!

6. Once you are satisfied that the unit is fully embedded onto the hull, you will notice that sealant has squeezed out from around the perimeter of the light. Using a cloth wipe off excess sealant to leave a clean seal. If you do not see sealant squeeze out from the body, you have not used enough sealant or tightened the unit enough to the hull. Carefully examine the installation to make sure the seal you have installed on the unit is fully water-tight. If in doubt, remove light, re-apply sealant and re-install.

3. Connecting the light fixture

Warning: Always consult a qualified electrician when connecting OceanLED light fixtures. When connecting light units, please note that all OceanLED lights will operate within a specific voltage range.

OceanLED Sport models require a 12/24V DC supply. This supply should be a minimum of 6A @ 12V DC or 3A @ 24V DC per light.

When connecting lights to your DC power source it is recommended to connect using a two pole screw type terminal block, with a minimum voltage rating of 50V and a current rating of at least 6A. (When installing multiple fixtures we recommend using the OceanLED 4-Way Power Junction Box). The ends of the cable should be stripped back (if required) and suitable ferrules fitted. The terminal block should be fixed inside a waterproof enclosure (IP66 minimum).

Note: Switch and breaker need to have sufficient current ratings to support light. For complete instructions on DC connections, please refer to ABYC codes of practice and other applicable codes and ordinances for DC connections.

Warning: Never leave the bare cables unprotected. Take care to not leave the bare wire ends in areas exposed to water before making the waterproof connections. Water deposits in the connectors and cables will cause corrosion. Over time water can also work its way into the unit along the inside of the cable due to capillary action causing the light to fail. This will NOT be covered under warranty.

1. Depending on the quantity of lights installed you will need to pull the **correct sized power cable** from the breaker/fuse panel to the light locations to supply constant power to the units. It is imperative that the correct sized tinned marine cable is used. For recommended cable gauges see full installation manual, available online.
2. If you are not installing a custom fuse panel, it is imperative that the OceanLED supplied fuse is installed on the power line from each light.
3. Using waterproof connections or IP66 waterproof junction boxes, make the connections from the fused DC power source(s) to the light(s). If appropriate always use a dielectric grease when making the connections and make sure any heat shrink used completely encapsulates the outer wire sheath (the use of glue-lined heat shrink is highly recommended to ensure water tightness).

NOTE: Corrosion of wire, and/or water ingress into the light unit via the cable is NOT covered under warranty.

4. Secure cabling ensuring where the cable exits the light it is not under stress.

4. Finalize your OceanLED installation

Test your lights

Always test the lights BEFORE the boat goes back into the water for a max. of 5 minutes. Failure to test prior to launch may require boat to be hauled out.

Warning: When installing a new light on a boat, always check for leaks immediately after placing it in the water. If any leaks are observed, take immediate action to prevent property damage.

5. Operation

Single Colour Strobe

To enter strobe mode, toggle the power on and off quickly twice, then back on. They should now strobe in a pseudo-random pattern. The lights can be reset from strobe mode after 20 seconds of use. Simply turn off then back on again.

Dual Colour Operation

The Dual colour change has seven modes of operation;

1. Solid White (default stage after power cycling)
2. Solid Blue
3. Fade White / Blue
4. Random Strobe White
5. Random Strobe Blue
6. Random Strobe White / Blue
7. 50% White and 50% Blue

To cycle between the above modes, turn off the light for less than 1 second, then back on again.

Multi-Colour or Colours DMX - Control with DC Switch

The Sport Multi-Colour or Colours DMX has three modes of operation:

1. Single Colour Mode (default mode - default white, or a previously selected colour).
2. Strobe Mode - to enter this mode, turn off the light for less than 1 second, then back on again.
3. Cycle / Programming Mode - to enter this mode toggle the power to the unit off twice for less than 1 second each time. The light will then slowly cycle and fade through the colour spectrum. It can be left in cycling if required, or alternatively, once the light shows the desired colour this can be stored by switching the light off for more than 2 seconds. When the light is switched back on it will be back in single colour mode, displaying the previously selected colour.

For more details (including the DMX operation) please refer to the full manual at: www.oceanled.com/sport

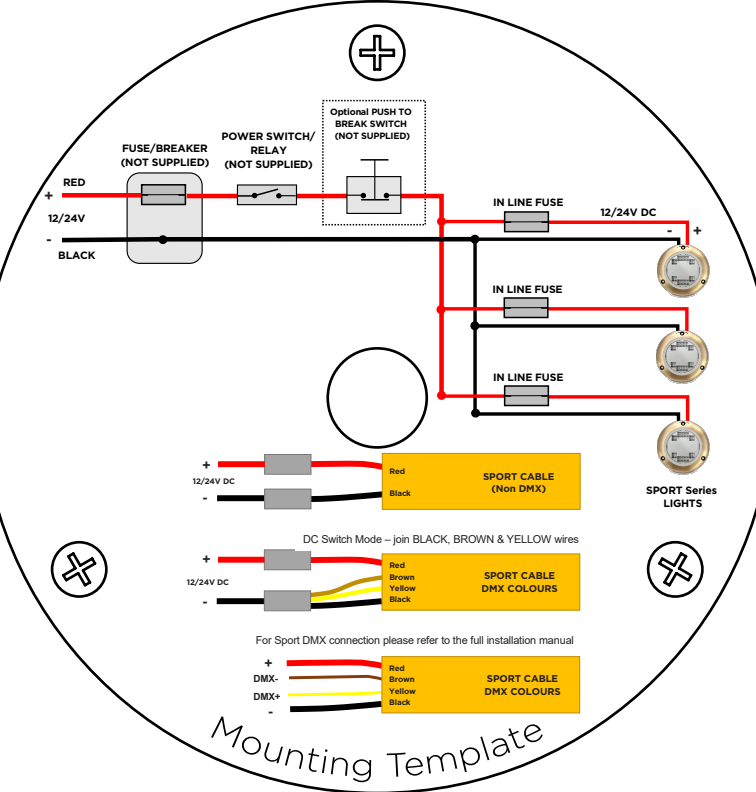

Mounting Template

