

Sport Colours DMX

SURFACE MOUNT UNDERWATER LIGHT

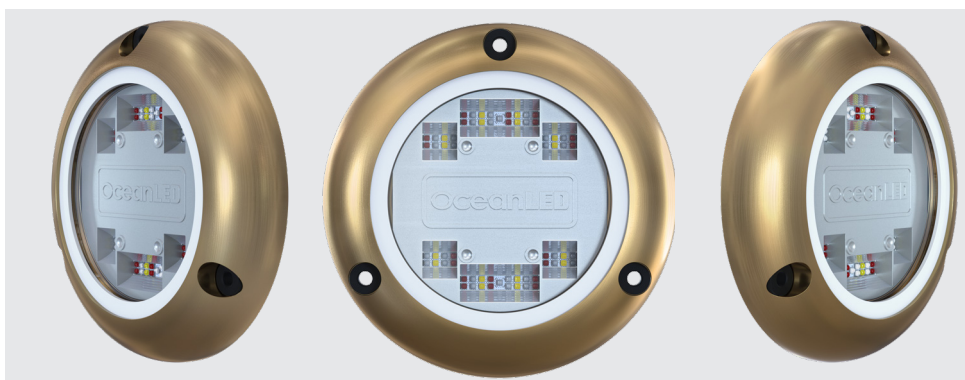

**3,500
Fixture
Lumens**

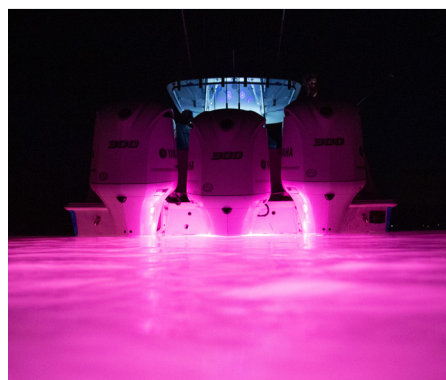

**Advanced
Optics**



**Ultra
Reliable**



**Easy
Install**



**Built-in
Driver**



**Full
Colour**



**Dynamic
Audio Mode**
(Compatible)



**Wave
Motion Mode**
(Compatible)

The Sport Colours DMX takes underwater lighting to breathtaking new heights. This ultra-reliable surface-mounted, full-color underwater light, is capable of producing up to 3,500 fixture lumens. Constructed using the finest marine-grade aluminum bronze, and certified to IP69K for water ingress protection, the Sport Colors DMX is the perfect choice for sport fishing vessels, leisure craft, and wake sports boats. Benefiting from our signature optics, creating a blade of light that cuts through the water in a way no other underwater lighting brand can match, the Sport Colours DMX leads it's class. Dramatically reducing light loss and creating unrivaled lighting effects.

IDEAL FOR ALL TYPES OF BOATS

Ideal for installation on all types of boat, the Sport Colours DMX can be used for everything from sport fishing and day boats, to pontoon boats, wake boats and even houseboats. Even boats left in the water for extended periods of time can benefit from Sport DMX lights. The state-of-the-art Tritonium coating protects our lights from underwater growth, allowing the owner or captain to simply wipe over the surface of the light, saving hours of scrubbing.

EASY INSTALLATION. SURFACE MOUNTED.

Thanks to its surface-mounted installation, the Sport Colours DMX is quick and easy to install. Just a single 12.5mm (0.5") hole is required for installation, perfect for those looking to install their lights themselves.

UNRIVALLED QUALITY. TESTED TO IP69K.

The Sport Colours DMX light has been rigorously tested to IP69K, the highest protection standard available, to ensure your complete peace of mind. The forged marine-grade aluminum bronze housing and specialist toughed colourless glass, provide an extremely tough outer surface. The addition of advanced seals mean the Sport Colours DMX is one of the most robust and long-lasting underwater lights available anywhere.

INTELLIGENT LIGHTING COMMANDS

The powerful, digitally enhanced internal microcontroller ensures high-speed efficiency and fast transient response. Built-in active thermal control (ATC) means you never have to worry about overheating. The light will automatically manage its own output and throttle-back as needed, to protect the LEDs.



IP69K CERTIFICATION

To achieve the IP69K rating, a piece of equipment must go through a rigorous water intrusion test. The product is placed on a turntable that rotates five times a minute. It's sprayed at 80 to 100 bar/1,160 to 1,450 PSI, in phases of 14 to 16 l/min, and at temperatures up to 176°F/80°C.

BESPOKE UNDERWATER OPTICS

The Sport Colours DMX light benefits from our signature underwater optics. Our unique optics have been specifically designed by our in-house team of expert engineers to supercharge a light's performance. With advanced light angling techniques, our optics focus the light to create a blade of light, that cuts through the water in a way no other underwater brand can match. The result is a light which uses far less power than its counterparts, draining less of your battery life whilst creating a superior effect.

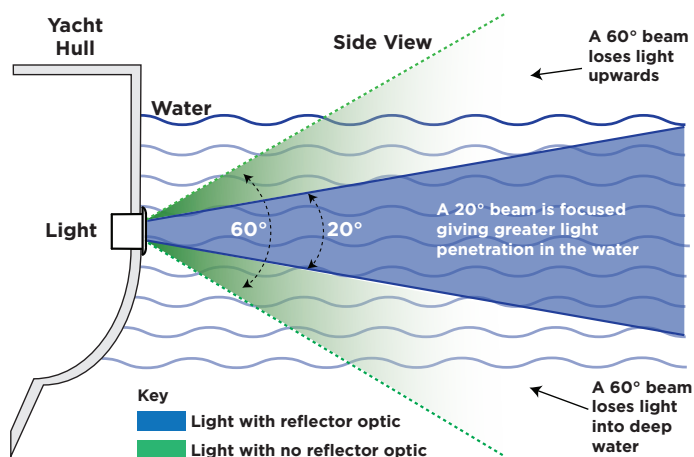

YOUR SYSTEM:



SPORT COLOURS DMX

Product Code: 012117CD
Full Colour DMX
Surface Mount



CONNECT POWER & FUSE KIT

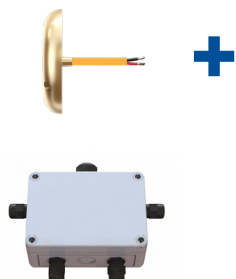

Fuse Kit
(Included with all models)



#013205
2-Way DMX Junction Box



LIGHT CONTROL

Option 1:

Switch Input
#012923

- Control Input Cable
- Terminator



Toggle the switch on and off to change colour and mode. See the installation manual

Option 2:

OceanBridge
#013201

- OceanBridge Unit



Option 3:

OceanDMX RC Kit
See Guide for detail

- OceanDMX RC Remote
- OceanDMX RC Receiver



SWITCH CONTROL / WIRING SCHEMATIC:

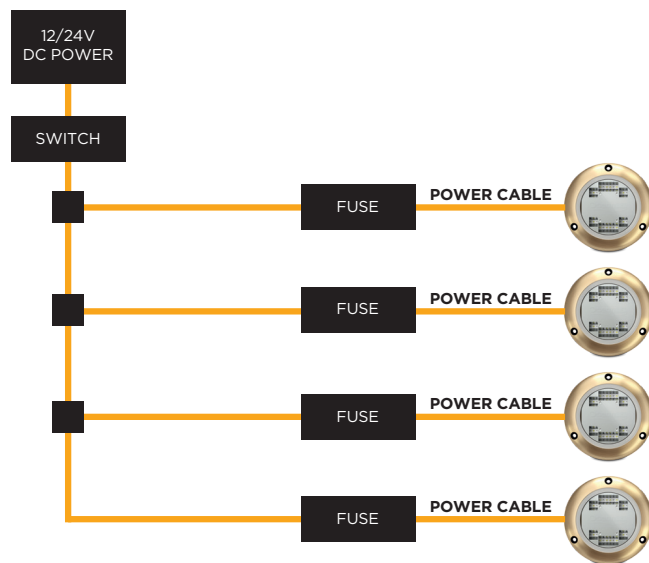

DMX CONTROL / WIRING SCHEMATIC:

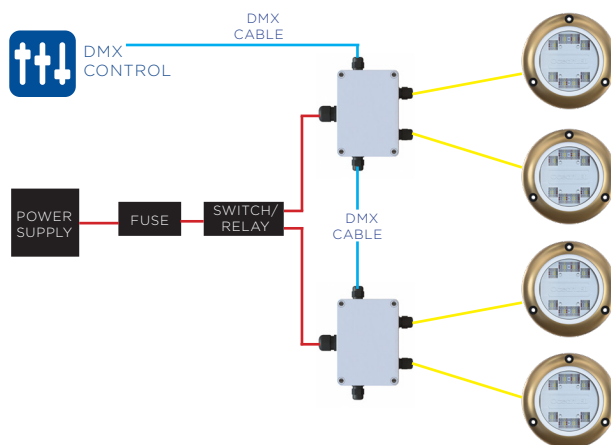

MODE & FUNCTION CAPABILITIES:



Static



Strobe



Audio Sync*



Cycle*



Sweep*



Movement-to-Colour*

*Controller dependent

IMPORTANT FEATURES

- **Full RGBW:** Universal colour selection and blending functionality when using the OceanBridge or OceanDMX RC Controller.

- **Active Thermal Control:** ATC prevents overheating. The intelligent internal driver reduces throttles back the lights brightness to protect the LEDs from overheating and causing damage.

MOUNTING RECOMMENDATIONS: TECHNICAL INFORMATION:

- Boat Size: Up to 65' (20m)
- Hull Spacing: 2ft-4ft
- Transom Quantity: 2-6 lights
- Install Depth: 8-10" (20-25cm)
Below the waterline

BOX CONTENTS:

- Sport Colours DMX (Part: 012117CD)
- In-Line Fuse Kit
- Mounting Screws
- Quick Install Guide

WARRANTY:

- Two Years

Water Protection Rating	IP69K	Fixture Lumens	3,500
Current/Power Consumption	12V DC 5.5A 24V DC 2.4A	Material	Aluminium Bronze
Min/Max Operating Voltage	9-32V DC	LED Life Expectancy	40,000+ Hours
Driver Type	Internal	Operating Temperature	-10°C to 50°C ambient
Beam Angle	90° x 20° Blade	No of LEDs	66
PHYSICAL			
Weight	700g	Hole Cut-Out	0.5" (12.5mm)
Cable Length	2m	Material	Aluminium Bronze
Footprint	3.93" (100mm)		

TRANSOM PLACEMENT:

Outboard

Example placement with twin outboard engines.

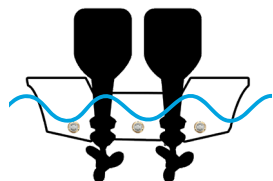

Inboard

Example placement for larger boats with inboard engines.

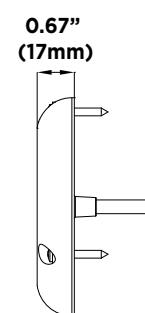
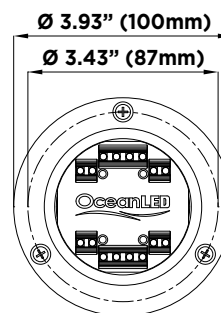
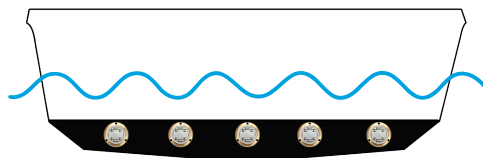

ACCESSORIES:

OPTIONAL JUNCTION BOXES	
Item	Part
2-Way DMX Junction Box	013205

OPTIONAL ISOLATION KIT	
Item	Part
Sport With Isolation Mounting Kit	019915

OPTIONAL CONTROLLERS	
Item	Part
OceanBridge Multizone Lighting Controller	013201
OceanDMX RC Sport/E3 Colours 915	013032
OceanDMX RC Sport/E3 Colours 868	013033

IMPORTANT NOTES:

Maintenance – Use a sponge or nylon brush with soap and water to clean your lights. A flexible straightedge may be used to remove growth on the lens or bezel if required. Do not use a jet wash on your lights.

Installation – All information provided in the installation manual represent normal installation instruction and is provided as guidance only. Please contact OceanLED for advice if you wish to install outside these parameters.

Disclaimer – OceanLED has taken care to ensure that the information provided in the literature is correct and up to date. However, it is not intended to form any part of a contract or provide a guarantee. Purchasers/ intending purchasers should contact OceanLED to check whether there have been any changes to the information since the publication of the literature. **Please ensure you have read the full installation guide before fitting this product.**

INSTALLATION (QUICK START GUIDE):

1. Test light(s) before fitting.
2. Apply a generous amount of the chosen sealant to the back perimeter of the light body (1). Ensure that the cable of the light is thoroughly coated where it meets the back of the light (2). There should be a continuous and unbroken bead of sealant around the perimeter of the light unit, including the screw holes and cable exit.

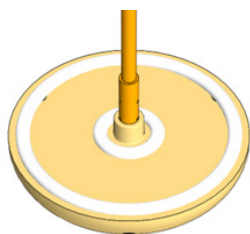

3. Insert the light on to the hull, feeding the cable through first, and then seat it into place. Press the light firmly onto the hull to ensure a secure and adhesive attachment.
4. To ensure proper dispersion of light underwater, make sure all Sport Lights are mounted with the correct orientation, with the logo (3) facing upwards.

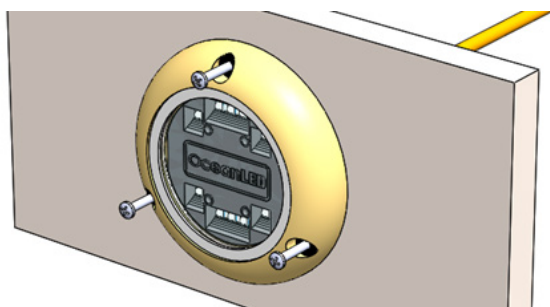

5. Cover the screw (4) threads with the sealant and screw into the pre-drilled pilot holes. Tighten the screws with a hand tool ONLY!

6. ELECTRICAL INSTALLATION:

Connecting light/s to your DC Power Source

OceanLED Sport models require a 12 or 24V DC supply. This supply should be a minimum of 6A @12V or 3A @ 24V DC per light.

Sport DMX Colours operated by switch

To use in DC switched mode; connect DC power +Ve to the RED wire, and DC power -Ve to the BLACK, BROWN & YELLOW wires

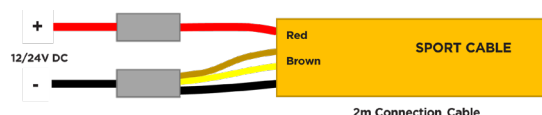

Sport DMX Colours operated by DMX controller

Please refer to the table below and consult the installation manual of the 2-way DMX Junction Box for connection method. This light requires a 2-way DMX Junction Box for efficient distribution of power and the DMX signal.

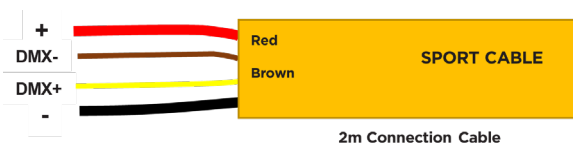

FOR FULL INSTALLATION INSTRUCTIONS, SEE THE INSTALLATION MANUAL.

SUSTAINABILITY

OceanLED is committed to a sustainable future. Through constant product and design innovation, establishing better working practices, and evaluating our supply chains, we are able to take measurable steps to creating true sustainability in our business.