



KEY FEATURES



13,000*
 Fixture Lumens
* Ultra White measurement



90°
 Top Beam



20°
 Side Beam



0° - 50° Beam
 Projection Angle

COLOUR



Dual White/Blue



Colours DMX

UNIQUE PATENTED INSTALLATION TECHNOLOGY

The Explore E9 brings to market an innovative evolution. The Unique Patented Installation Technology allows for in-water connection and removal, as well as installation in the hull areas usually inaccessible, for example tanks and void spaces such as the bulbous bow. The E9, alongside the E8 now completes the Explore range allowing for an uninterrupted halo of light.

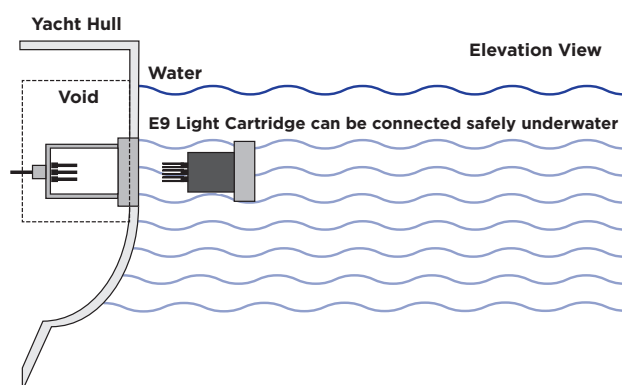

IP69k SUPERIOR PROTECTION, TOTAL PEACE OF MIND



IP69k, the highest achievable rating of protection against water ingress. IP69k goes one step further than the industry standard IP68, giving you additional protection and peace of mind.

BENEFITS OF E8 & E9 ANGLED OPTICS

Create A Uniform Lighting Effect Around Your Yacht

- Choice of Angled optics to counter the hull shape.
- 0°, 10°, 20°, 30°, 40° & 50° Beam projection angles.
- 0° Cofferdam for minimal effect on laminar flow due to flush hull installation.

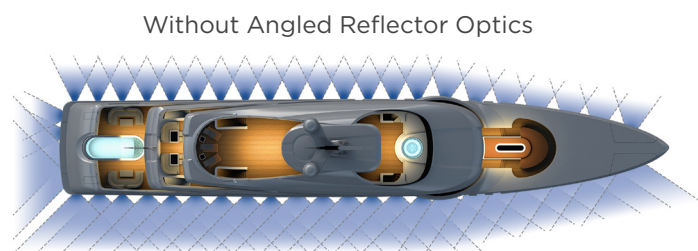

Without Angled Reflector Optics

With Angled Reflector Optics

- The Explore E8 & E9 angle the beam up to 50°, while housed in a 0° cofferdam, using highly efficient reflector optics which produce the best possible uniform lighting effect; a complete halo of light around the yacht.

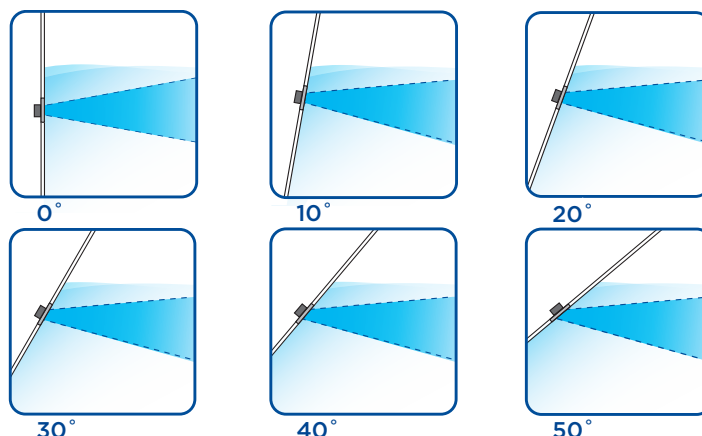

LESS POWER USED AND SUPERIOR LIGHTING EFFECT



Less power used to deliver superior light effect due to advanced Optics

- New generation innovative, efficient reflector optics.
- Focused side beam produces a blade of light under the water that penetrates further.
- All available light is directed with minimal loss.

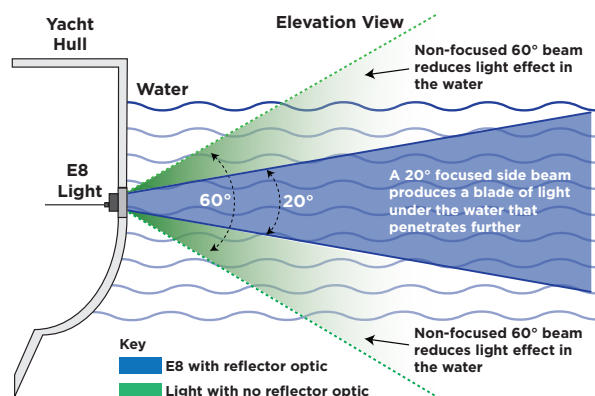

E8 EXPLODED VIEW

Rear Cofferdam available on request. Contact OceanLED's custom project management team for further details.

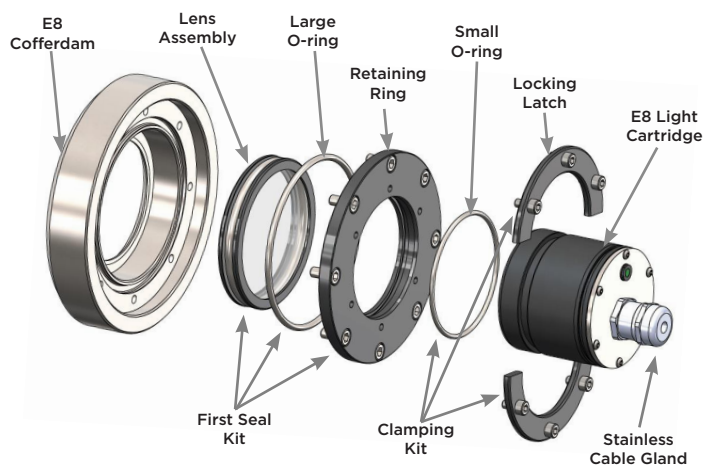

E9 EXPLODED VIEW

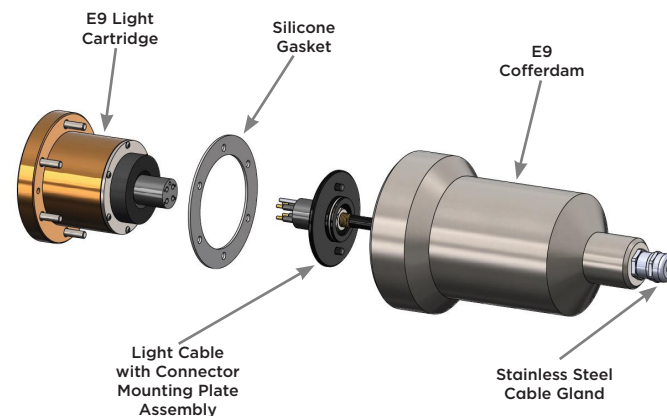

E8 / E9 SYSTEM EXAMPLE SCHEMATIC

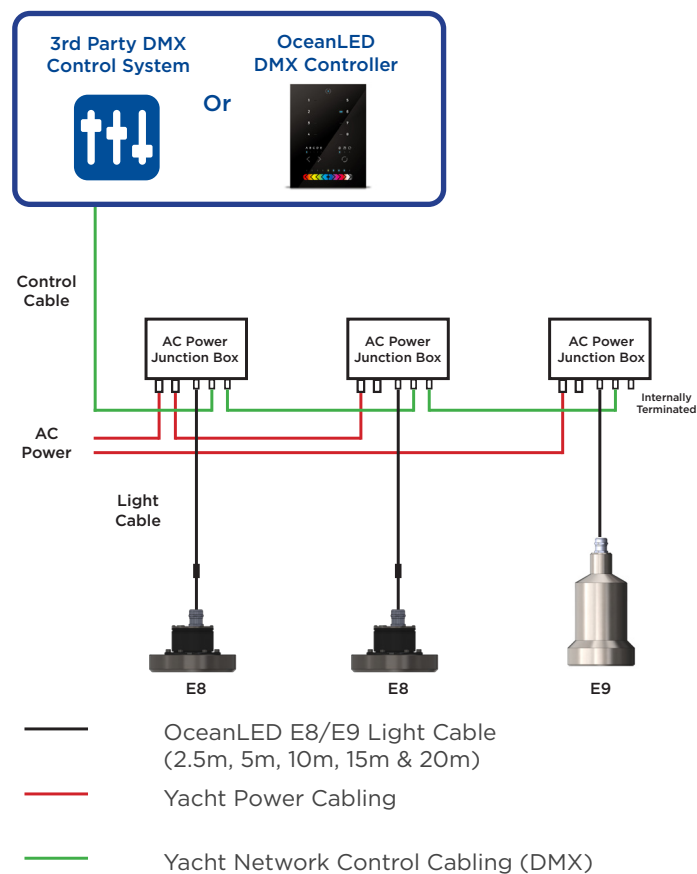

Please contact OceanLED for assistance and advice with connection and integration of your Explore E8 or E9 underwater lighting system.

CHOOSE YOUR LIGHT SETUP

Explore E8 for areas accessible from inside the vessel
OPTION 1 - E8
 Explore E9 for in-accessible areas such as tanks or voids
OPTION 2 - E9

+

LIGHT: Choose between Dual Colour Midnight Blue / Ultra White or Colours DMX
OPTION 1 - DUAL
OPTION 2 - COLOURS

+

COFFERDAM: Choose between Aluminium or Stainless Steel
OPTION 1 - ALUMINIUM
OPTION 2 - STAINLESS STEEL

+

BEAM ANGLE: Choose internal beam angling
OPTION 1 - 0° **OPTION 2 - 10°** **OPTION 3 - 20°**
OPTION 4 - 30° **OPTION 5 - 40°** **OPTION 6 - 50°**

+

POWER: AC or DC
OPTION 1 - AC POWER JUNCTION BOX
OPTION 2 - DC JUNCTION BOX

+

CONTROL: Choose the method of how you control your lights
OPTION 1 - 3rd PARTY
OPTION 2 - OCEANLED CONTROLLER

+

CABLE: Choose your required cable lengths
OPTION 1 - 2.5M **OPTION 2 - 5M** **OPTION 3 - 10M**
OPTION 4 - 15M **OPTION 5 - 20M**

PROJECT MANAGEMENT TO COMMISSIONING

- Our experienced custom project management team will work with you from initial concept through to system commissioning.
- We will work closely with your team to understand and overcome the challenges presented throughout the build process.
- Delivering a tailored underwater lighting system; achieving the clients desired lighting effect.
- OceanLED will work with you to deliver in-line with your build schedule; keeping you informed of progress throughout.
- Should you require it, OceanLED offers a commissioning service for complete peace of mind.

DIMENSIONS - E8 WITH COFFERDAM

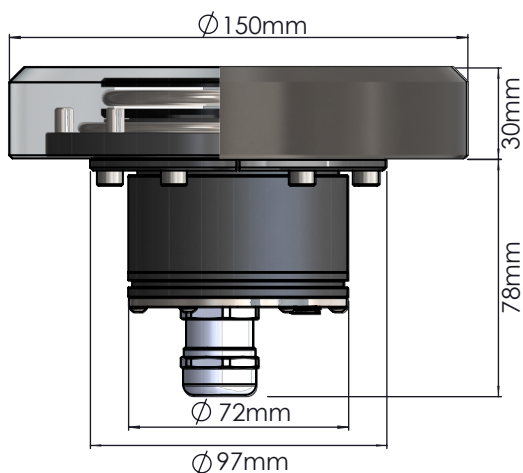

DIMENSIONS - E9 COFFERDAM

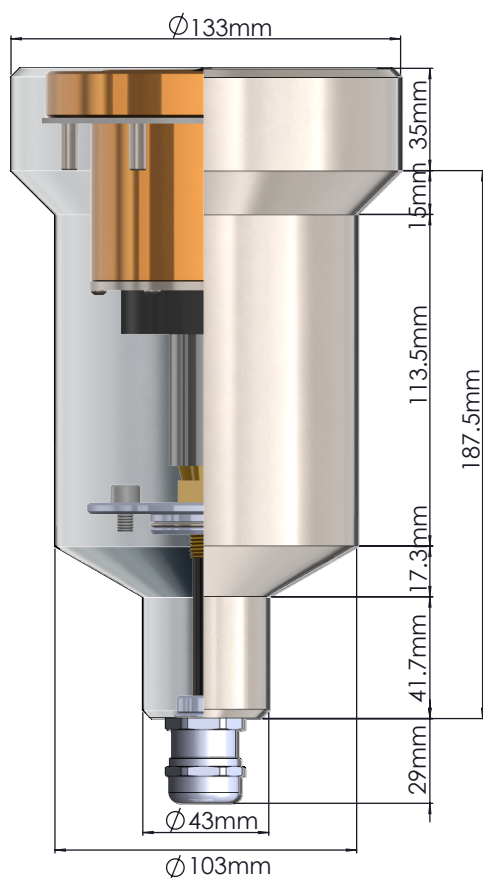

AC POWER JUNCTION BOX

| | |
|--|--|
| Height, Width, Depth Minimum Clearance Zone | 150mm x 233mm x 133mm 250mm x 253mm |
| Material / Colour | Steel / RAL 7035 |
| Weight | 2.4kg |
| IP Rating | IP65 |
| Maximum Ambient Temperature | 50°C |

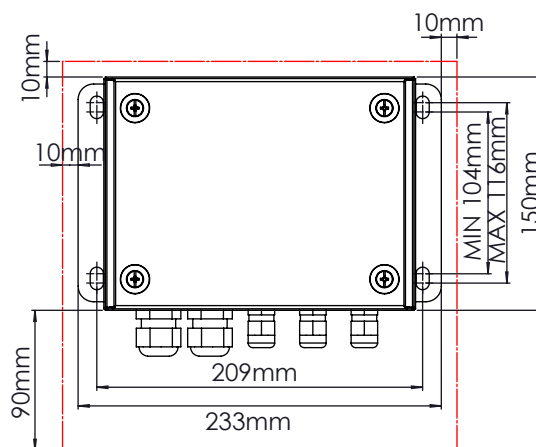

MINIMUM CLEARANCE ZONE

DC JUNCTION BOX

| | |
|--|-------------------------------------|
| Height, Width, Depth Minimum Clearance Zone | 94mm x 94mm x 58mm 194mm x 274mm |
| Material / Colour | Polymer / RAL 7035 |
| Weight | 0.3kg |
| IP Rating | IP65 |
| Maximum Ambient Temperature | 50°C |

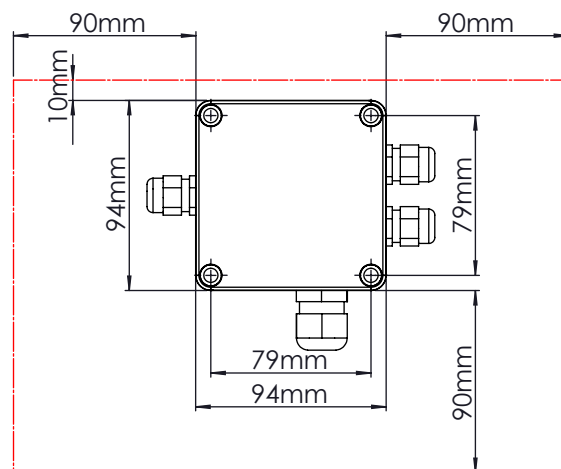

MINIMUM CLEARANCE ZONE

For welding procedures, please contact your relevant classification surveyor or society.

PRODUCT GUIDE/technical

EXPLORE E8/E9 WELD-IN



| TECHNICAL | |
|--|--|
| Fixture Lumens (Total light output from a finished fixture) | Dual – 13,000* Colours – 6,000* |
| Optics | Linear Micro-Faceted Reflector |
| No Of LEDs | Dual - 18 W, 17 B Colours - 25 R, 19 G, 20 B, 20 W |
| Beam Angle | 90° x 20° |
| Angled Optics Options | 0°, 10°, 20°, 30°, 40° & 50° |
| Min-Max Operating Voltage DC | 20V – 32V DC |
| Min-Max Operating Voltage AC | 100-240V 50/60Hz |
| Power | Dual – 113W Colours – 82W |
| Current / Amp Draw (DC) | Dual - 4.7A @ 24V DC Colours - 3.2A @ 24V DC |
| Current / Amp Draw (AC) | 110V AC 1.25A 230V AC 0.65A |
| Driver Type | Internal |
| Connectivity Options | DC Junction Box AC Power Junction Box |
| Correlated Colour Temp. | 6500K White |
| IP Rating | IP69k Front Face, When Installed |
| Approx. Light Penetration | Avg. Water Quality - 13.5m Perfect Water Quality - 32m+ |
| Minimum Light Cable Bend Radius | 75mm |

*Ultra White measurement

| APPROVALS & WARRANTY EXPLORE E8 | |
|---------------------------------|---------|
| Lloyds | |
| RINA | |
| ABS | |
| DNV-GL | Pending |
| Warranty | 3 Years |

| PHYSICAL E8 | |
|--|--|
| Total Diameter of Cofferdam | 150mm |
| Diameter of Light Cartridge | 72mm |
| Overall Length | 163mm / 108mm with / w/o Rear Cofferdam |
| Total Weight (Stainless Steel Cofferdam) | 3.2 kg (7.05lbs) |
| Total Weight (Aluminium Cofferdam) | 1.75 kg (3.86lbs) |
| Total Weight - inc Rear Cofferdam (Stainless Steel Cofferdam) | 8.6 kg (18.96lbs) |
| Total Weight - inc Rear Cofferdam (Aluminium Cofferdam) | 3.55 kg (7.83lbs) |
| Rear Cable Stub Length | 0.3m |
| Cofferdam Material | Aluminium / Stainless Steel 3.2 Certified |
| Light Body Material | Aluminium |

| PHYSICAL E9 | |
|--|--|
| Total Diameter of Cofferdam | 133mm |
| Diameter of Light Cartridge | 110mm |
| Overall Length | 252mm |
| Total Weight - With Cofferdam (Stainless Steel) | 8.4 kg (18.52lbs) |
| Total Weight - With Cofferdam (Aluminium) | 4.2 kg (9.96lbs) |
| Cable | Max 20m to junction box |
| Cofferdam Material | Aluminium / Stainless Steel 3.2 Certified |
| Light Body Material | Aluminium Bronze |

| APPROVALS & WARRANTY EXPLORE E9 | |
|---------------------------------|---------|
| Lloyds | |
| RINA | |
| ABS | |
| DNV-GL | Pending |
| Warranty | 3 Years |
| Patented | |