

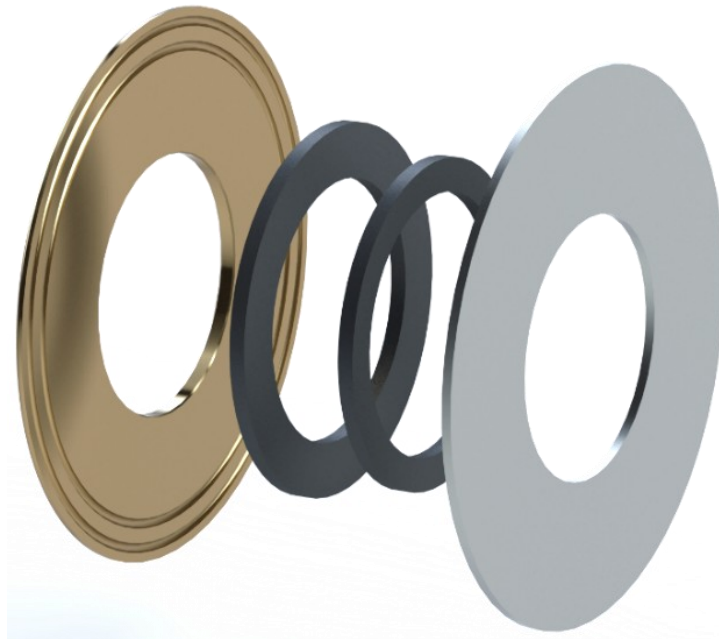

INSTALLATION MANUAL

Pro-Series to Explore Upgrade Kit Installation Manual



Preface

READ AND FOLLOW ALL INSTRUCTIONS IN THIS MANUAL

WARNINGS

Before installing your OceanLED product, read and follow all warning notices and instructions which are included. Failure to follow safety warnings and instructions can result in property damage, severe injury or even death.

Before installing your OceanLED product, check local laws for restrictions regarding the use of coloured lights in your area.

Do not operate lights out of water for a period longer than 5 minutes. Any time lights are switched on out of water, lights should be switched OFF for a period of at least 1 hour. Exceeding this may cause damage to the light unit.

Salt is an inherently corrosive material. Metal parts and certain natural and man-made surfaces are particularly susceptible to corrosion and deterioration when used in and around saltwater.

Some OceanLED lights contain combinations of plastic and polymer products which are impervious to saltwater corrosion, however, screws and fasteners used for the installation must be of a marine grade type stainless steel or equivalent and monitored annually to ensure the lights remain in service for years to come.

Never connect/disconnect lights with power applied as irreversible damage may occur. Ensure polarity of power connections is correct. Failure to do this may invalidate warranty.

Ensure lights are always fully submerged and not fitted on planning / running surfaces that may impact on water since this may damage the product. Also ensure the rear of the light is in a dry area and not subject to a wet environment. Failure to do this may invalidate warranty.

Never Use Solvents! Cleaners, fuel, and other products that may contain strong solvents, such as acetone, that attack many plastics greatly reducing their strength and irreversibly damaging the special lens coatings and cable sheathings.

Never clean lights using a high-pressure jet wash.

DANGER **RISK OF ELECTRIC SHOCK OR ELECTROCUTION**

Underwater lights must be installed by a licensed or certified electrician in accordance with all applicable local codes and ordinances. Improper installation will create an electrical hazard which could result in death or serious injury to swimmers, installers, or others due to electrical shock, and may also cause damage to property. Always disconnect the power to the light at the circuit breaker before servicing the light.

Contents

1 Preparing the Hull	5
1.1 Hull Thickness Requirements	5
1.2 Supported Hole Cut Out Size Range	5
1.3 Existing Light Removal	5
2 Installation	6
2.1 Installing the Pro-Series to Explore Upgrade Kit	6
2.2 Finalising The Installation	13
2.3 Essential Test.....	14
3 Appendix	15
3.1 Overall Dimensions.....	15
4 Warranty	17

IMPORTANT NOTICE

Attention Installer: This manual contains important information about the installation, operation, and safe use of this product. This information should be given to the owner and/ or operator of this equipment.

WARRANTY COVERAGE

Please refer to www.oceanled.com/warranty for full warranty statement.

1 Preparing the Hull



When installing a Pro-Series to Explore Upgrade Kit and Explore XFM light unit, it is important to ensure that there is sufficient space inside the vessel to remove the insert for maintenance or after-sales services. For example, the XFM unit requires an additional 100mm / 4" of space from the rear of the mounting tube to allow for insert removal. Please refer to the overall dimensions in Appendix (Section 3.1).

Make sure that the area surrounding the light inside the vessel has a diameter of 180mm / 7" free from any insulation material to allow the Pro-Series to Explore Upgrade Kit to sit tight to the hull.

OceanLED recommends using a qualified installer or technician for any modifications to your vessel. Additionally, please consult the manufacturer for more detailed information regarding modifications and installation procedures.

If lights are to be fitted to a wooden or conductive (e.g. steel, aluminium or carbon) hull, an Isolation Kit must be used. Contact OceanLED for additional details.

DELTRIN ISOLATION KIT (for Pro-Series to Explore Upgrade Kit)

Isolation of the metal parts of the Explore XFM Series Light from conductive or wooden hulls to prevent galvanic corrosion issues. The isolation kit is easily fitted to the rear of the light fixture using a suitable adhesive.

PART NUMBER

019917 - Pro-Series to Explore Isolation Kit

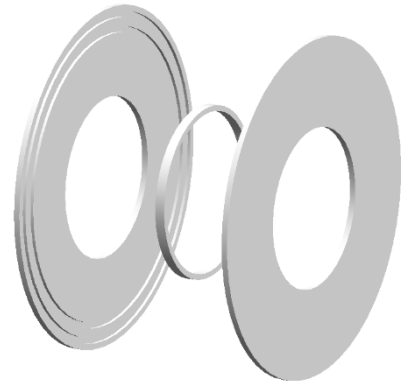

1.1 HULL THICKNESS REQUIREMENTS

Maximum hull thickness:

- Standard – 46 mm (1.81 in)
- With optional extension kit – 110 mm (4.33 in)

1.2 SUPPORTED HOLE CUT OUT SIZE RANGE

Hull hole cut out size – The Pro-Series to Explore Upgrade Kit is suitable for use with an existing hole cutout from 90 mm up to 120 mm in diameter (3.54 in - 4.72 in).

1.3 EXISTING LIGHT REMOVAL

Once the existing light(s) have been removed from the hull, ensure that all sealant and adhesive is removed from within and around the existing hole, and that the surface is free from damage or other contaminants. This will ensure effective bonding when installing the Pro-Series to Explore Upgrade Kit.

2 Installation

2.1 INSTALLING THE PRO-SERIES TO EXPLORE UPGRADE KIT

Pro-Series to Explore Upgrade Kit Includes

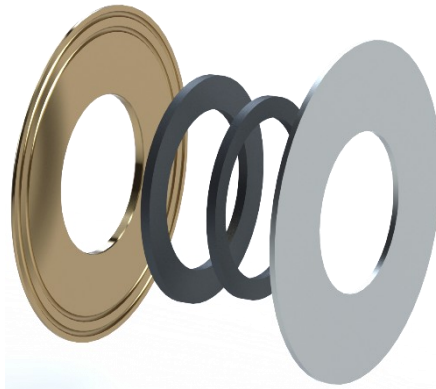

Pro-Series to Explore Upgrade Kit
(Product Code: 019916)

Additional tools / items required not supplied by OceanLED:

- Marine sealant - 3M 4200 or equivalent
- Allen key (5mm)
- Torque wrench – 5mm hex bit
- Thread lock - Loctite 243 or equivalent.

 **DO NOT** remove the Explore light cartridge from the Explore mounting tube during installation. The light cartridge **MUST** stay fitted inside the Explore mounting tube throughout the installation process to avoid the introduction of potential contaminants that may damage the product. The light cartridge can only be removed for maintenance or after sales purposes and OceanLED must be contacted prior to any light cartridge being removed from the mounting tube.

 OceanLED recommends dry fitting (assembling without sealant first to check alignment) all products. When installing, be sure that the Pro-Series to Explore Upgrade Kit fits the area and secures to the hull using the appropriate hardware before applying any sealant.

 When applying sealant to the light fixture, use OceanLED packaging material such as the light cardboard box when placing the light on the ground face down to prevent lens damage.

Installation Overview

Supported Hole Cut Out Size Range:
90-120mm / 3.57-4.72"

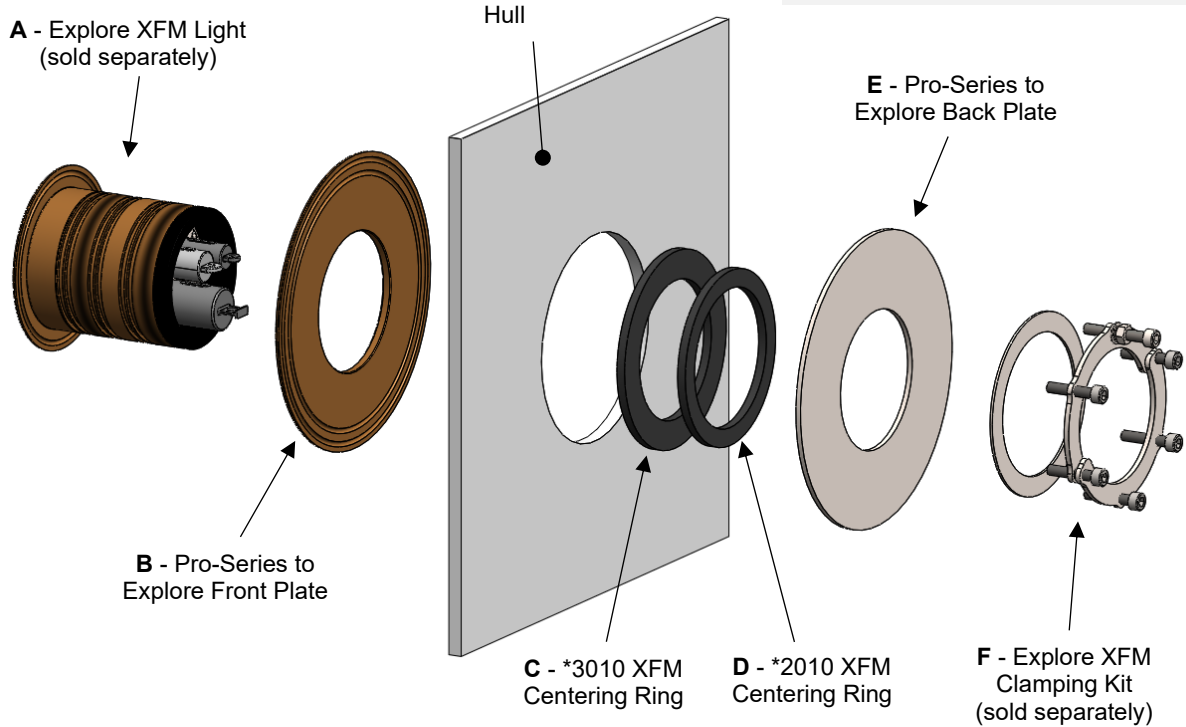

* Use one of the centering rings (C or D) depending on hole cutout size – see install instructions

Exploded View of the Assembly (Non-conductive Hull)

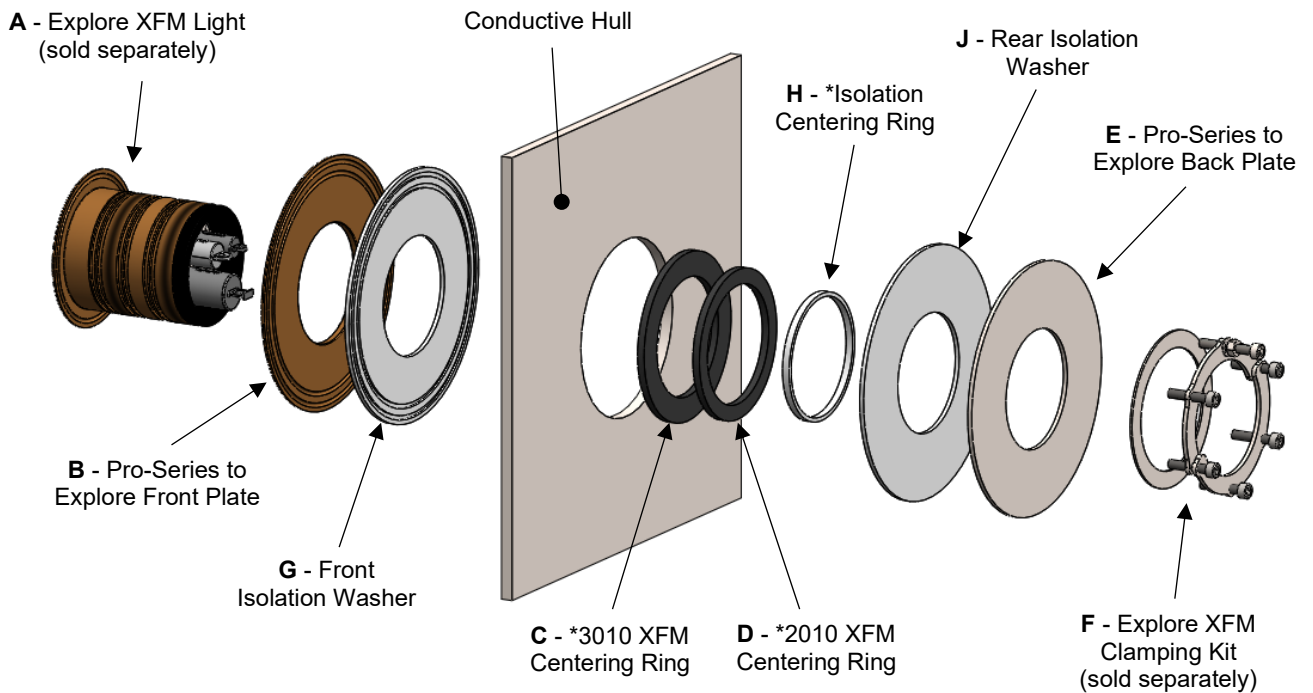

* Use one of the centering rings (C, D, or H) depending on hole cutout size – see install instructions

Note: Parts G, H and J come as separate kit - P/N: 019917 - Pro-Series to Explore Isolation Kit

Exploded View of the Assembly with the Isolating Kit (Conductive Hull)

Installation (Once hull preparation is complete)

1. Before proceeding with the fitting of the Explore light(s), it is essential to test them to ensure correct functionality. Testing the lights prior to installation allows you to verify that they are operating correctly and producing the desired illumination. Once the lights have been tested and confirmed to be in proper working condition, they can be installed in the hull.
2. Apply sealant (3M 4200 or equivalent) to the rear of the mounting tube assembly's bezel (A) and Pro-Series to Explore Front Plate (B) to ensure a complete and unbroken seal around the light and front mounting plate. Make sure sealant fills in the recess grooves on both components.

When using the isolating kit for a conductive hull, additionally apply sealant to the rear (grooved side) of the front isolation washer (G).

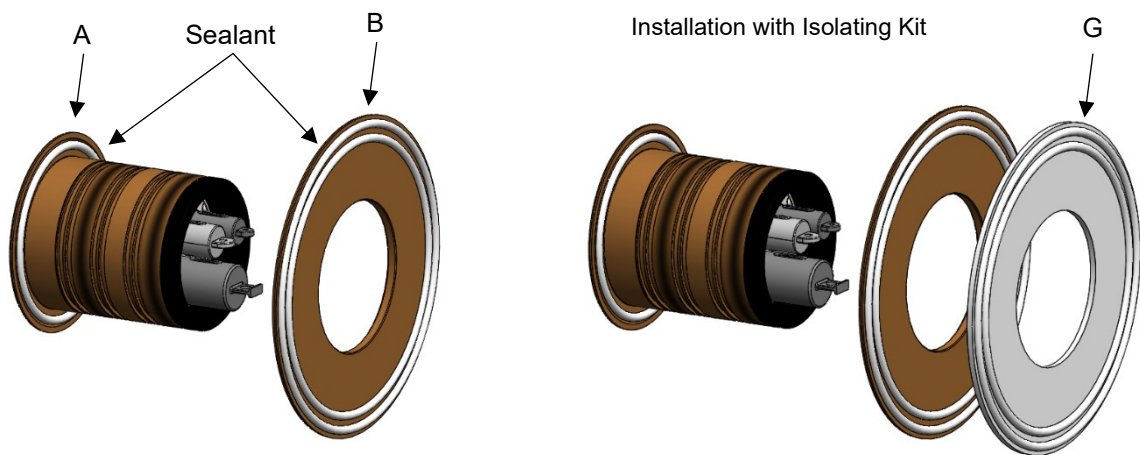

3. To ensure your Explore XFM underwater light is orientated correctly when installed, refer to the relevant Explore XFM light manual for further instructions: <https://www.oceanled.com/products>
 - [MAN-000029 – Explore E3 Manual](#)
 - [MAN-000051 – Explore E3 Colours DMX Manual](#)
 - [MAN-000044 – Explore E6 & E7 XFM Manual](#)
 - [MAN-000050 – Explore E6 & E7 XFM Single Colour Manual](#)
4. Insert the complete light unit (mounting tube assembly and light cartridge) (A) together with the Pro-Series to Explore Front Plate (B) into the hull. Press the light and mounting plate firmly against the hull and twist slightly to spread the sealant behind the light and mounting plate to ensure good adhesion.

When using the isolating kit for a conductive hull, install the front isolation washer (G) first, followed by the front plate (B) and then the light unit (A).



This process is made much easier if a second person is inside the hull to receive the light and install the locking equipment whilst supporting the light from the outside. Breakages due to lights falling out of the hull are NOT covered under warranty and can cause serious bodily injury as can any falling object.

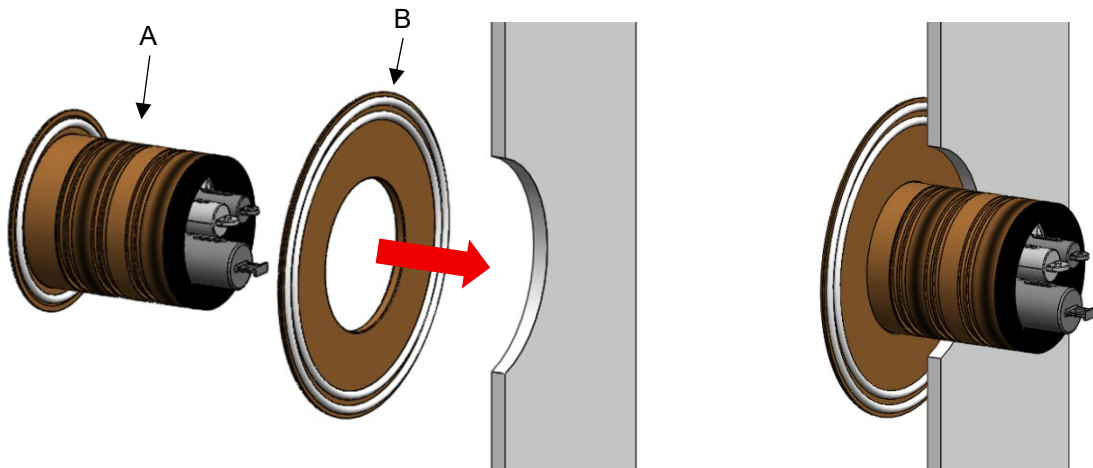

Installation with Isolating Kit

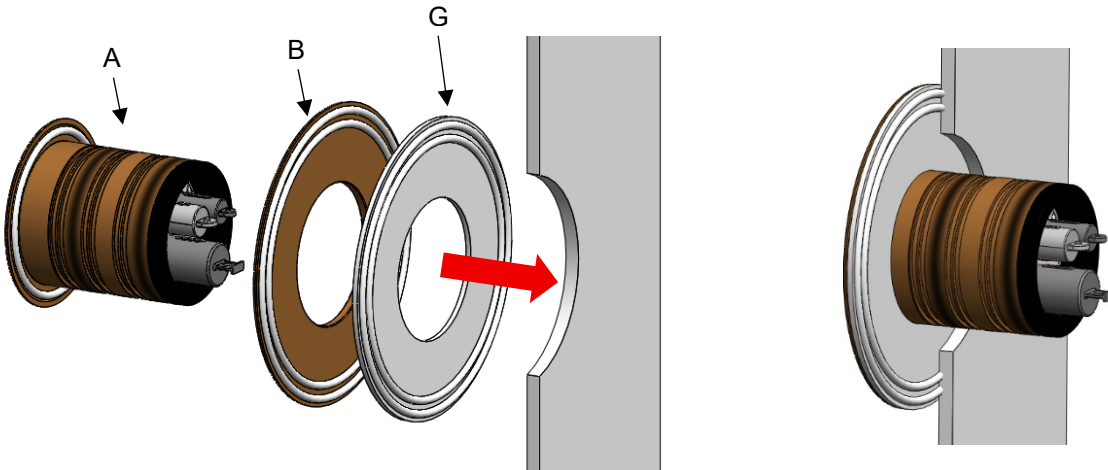

- From inside the vessel, place the appropriate centering ring over the rear of the Explore XFM light to centre the light within the hull cut-out. Select the correct centering ring according to the Centering Ring Selection Guide below.

When using the isolating kit for a conductive hull, ensure the correct centering ring is selected as specified in the table.

Centering Ring Selection Guide

Centering Ring	Part Reference	Suitable Hull Cut-Out Diameter
3010 Centering Ring	(C)	120 mm – 115 mm (4.72 in – 4.53 in)
2010 Centering Ring	(D)	115 mm – 102 mm (4.53 in – 4.02 in)
Isolation Centering Ring	(H)	102 mm – 90 mm (4.02 in – 3.54 in) – Conductive hulls only
No Centering Ring Required	-	Below 102 mm (4.02 in) for non- conductive hulls

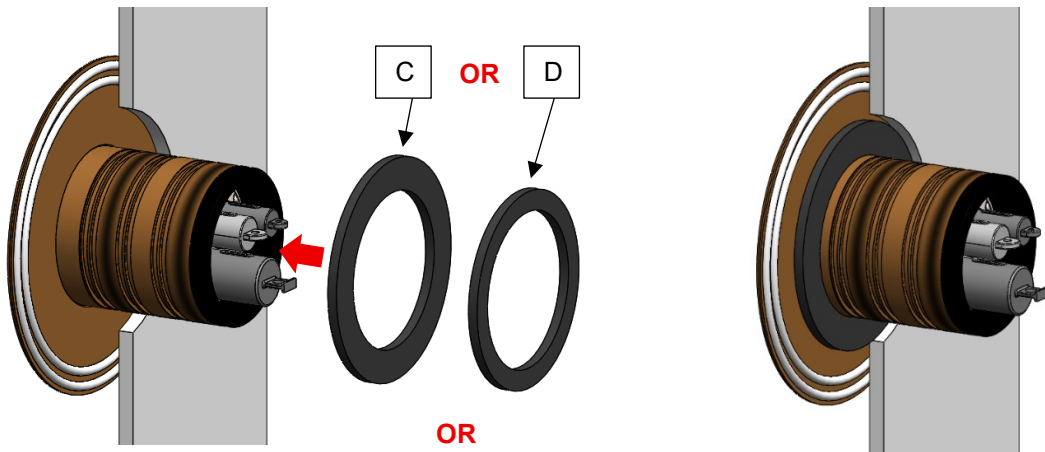

If the hole diameter is less than 102 mm (4.02 in), no centering ring is required.

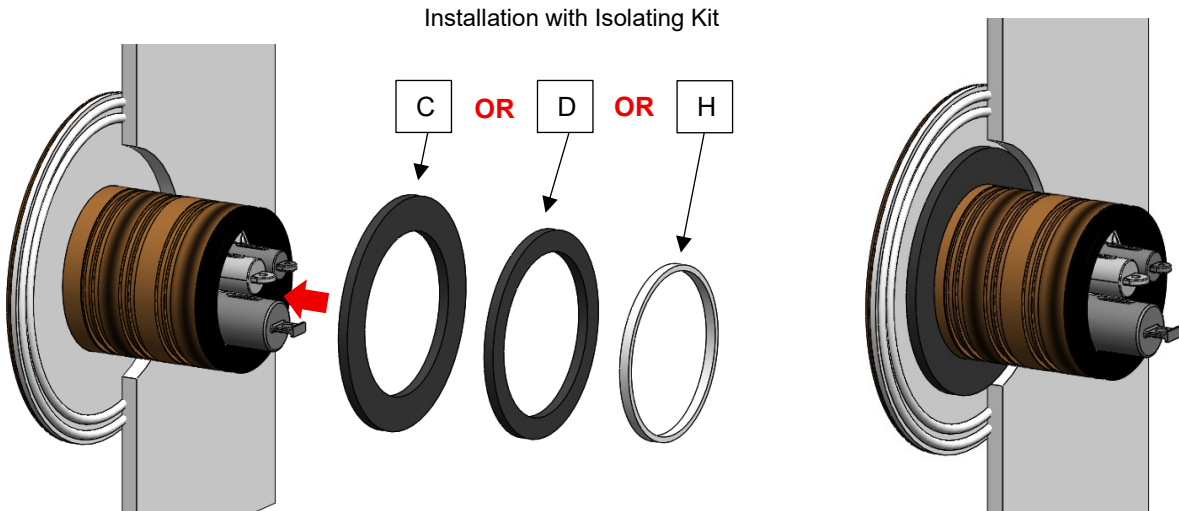

Note: The Isolation Centering Ring (H) must be used when installing the isolating kit on conductive hulls with hole diameters below 102 mm (4.02 in).

- Then place the Pro-Series to Explore Back Plate (E) over the back of the light.

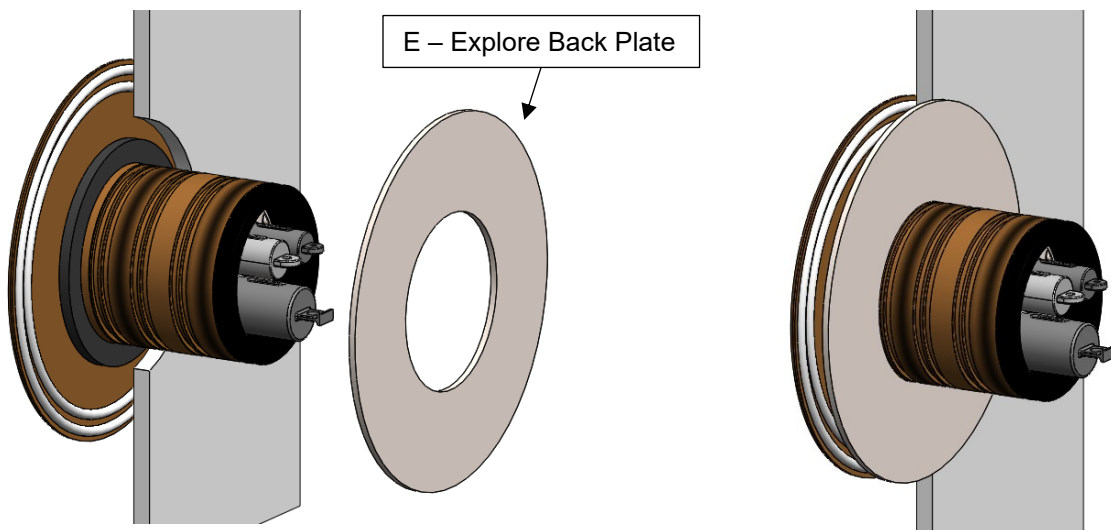

When using the isolating kit for a conductive hull, install the rear isolation washer (J) first, and then the Explore Back Plate (E).

Installation with Isolating Kit

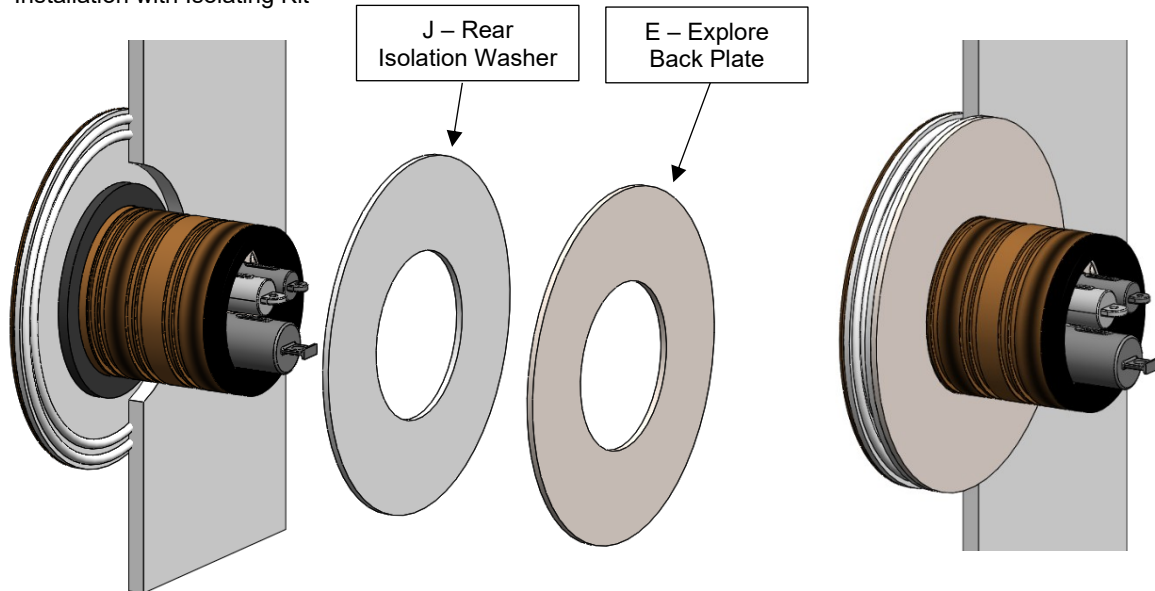

- Place the compression washer ① over the back of the light, followed by the two Clamping Clips ② and align them to form a circle, ensuring that you pair one threaded hole with one non-threaded hole. Use one of the shorter provided locking screws ③ to secure the clips together, positioning them approximately halfway down the length of the screw. Insert the clips into the appropriate grooves on the outside of the mounting tube ④, considering the hull thickness. Make sure the end of the screw is close to the washer. Use the remaining screws to fix the two clips together. Keep the longer screw aside for connecting the light to the vessel's cathodic protection system. Once connected, tighten this screw to the same position as the others.

Follow the same process for installation with isolating kit.

*Items 1 to 4 are supplied with the Explore XFM light

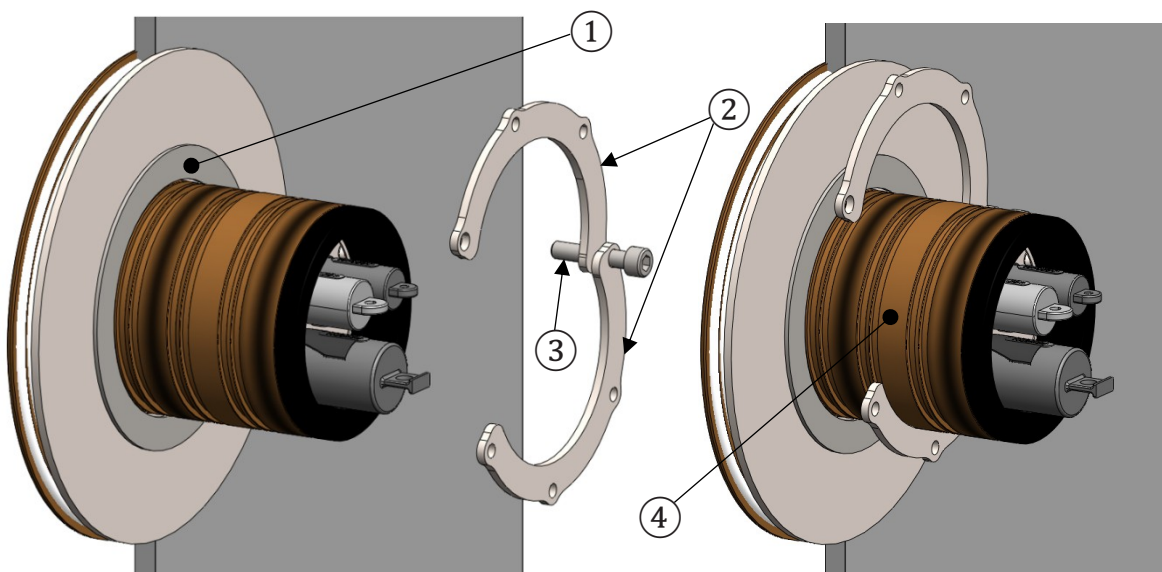

8. Using a 5mm Allen key, tighten the remaining 4x shorter locking screws ③ shown below, ensuring that you apply thread lock at the point where the threads contact the clamping clips ②. **Using the torque wrench, apply a torque of 2 Nm.** Take care not to over-tighten the locking screws, as this could potentially damage the mounting tube and/or mounting kit plates. Please note that any damage caused by over-tightening will not be covered under warranty.

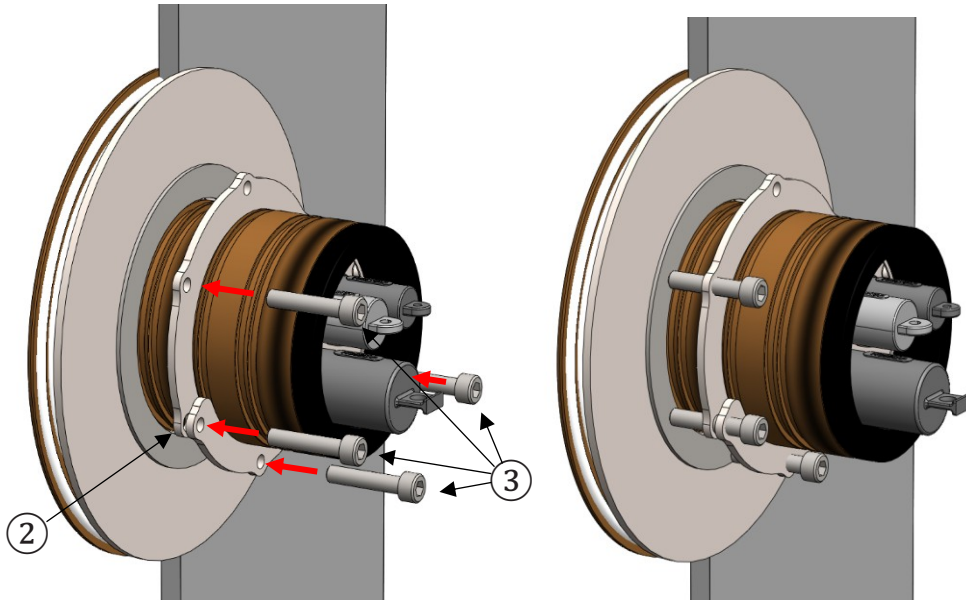

9. Sealant should squeeze out around the edges of the Explore XFM light (A) and the Pro-Series to Explore Front Plate (B), and, when using the isolation kit, around the Front Isolation Washer (G). Apply a suitable thinner or cleaner to a cloth and carefully wipe away any excess sealant to ensure a clean finish. **Avoid contact with the lens.**

If sealant does not squeeze out around the light body, this indicates that insufficient sealant has been applied or that the unit has not been tightened sufficiently against the hull. Inspect the installation carefully to ensure the seal is completely watertight. If you have any doubt, remove the light, reapply sealant, and reinstall.

10. Attach the vessel's bonding cable ⑤ to the remaining locking screw ③ and secure it in place using the provided nut and shake-proof washer. Use a 5mm Allen key to tighten the locking screw ③, applying thread lock at the point where the threads contact the clamping clips ②.

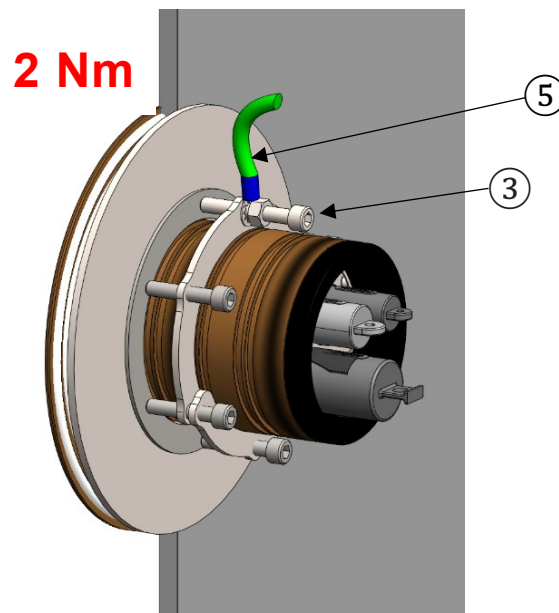



BONDING: It is essential to connect the light to the vessel's bonding/cathodic protection system. After installation, it is mandatory to ensure that there is uninterrupted continuity between the vessel's cathodic protection system and the Pro-Series to Explore Front Plate. Please refer to Section 2.2 for continuity testing procedure.

11. For the electrical installation and initial light setup, please follow the installation manual for your specific Explore XFM underwater lighting product: <https://www.oceanled.com/products>

- [MAN-000029 – Explore E3 Manual](#)
- [MAN-000051 – Explore E3 Colours DMX Manual](#)
- [MAN-000044 – Explore E6 & E7 XFM Manual](#)
- [MAN-000050 – Explore E6 & E7 XFM Single Colour Manual](#)

2.2 FINALISING THE INSTALLATION

The Explore XFM mounting tube and the Pro-Series to Explore Front Plate are constructed from corrosion resistant Aluminium Bronze and do not require further protection. The glass of the light unit is pre-coated with a specialized Tritonium® coating which makes the surface of the glass lens a non-stick layer. Do not apply any additional coatings, such as foul-release products, to the front of the lens without consulting OceanLED. Failure to do so will void your warranty.

OceanLED does not recommend that bottom paint or any type of anti-fouling agent is applied to the glass and/or bezel, as damage may occur due to chemical incompatibility. If bottom painting of the bezel is deemed essential, then an area of at least 5mm must be left uncoated around the glass lens.

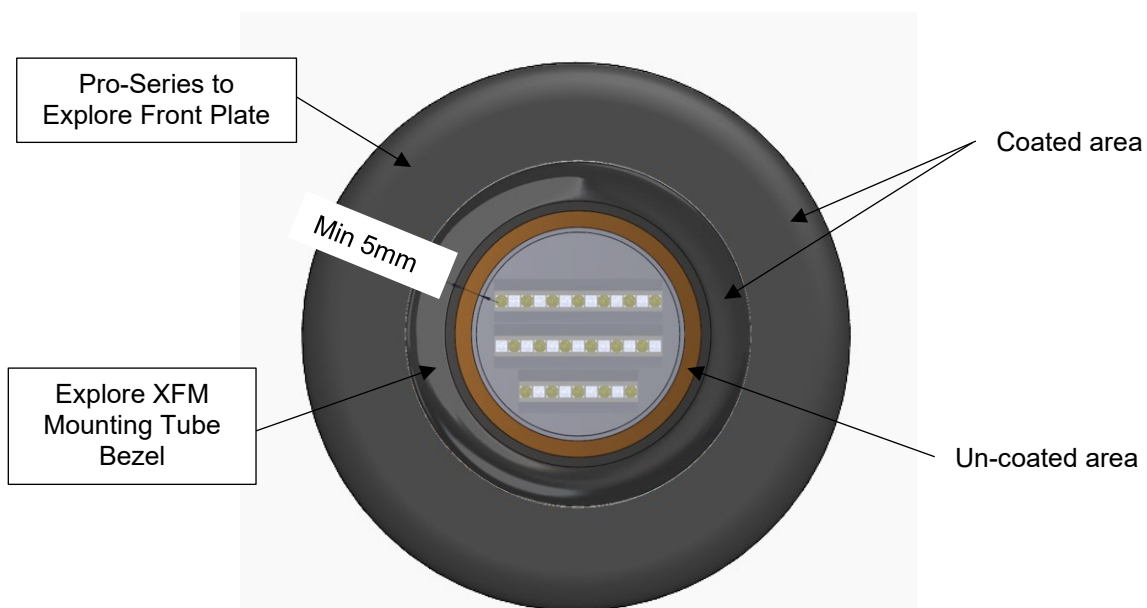

The protective lens sticker should be removed once all work on the vessel is complete.



Do not coat the light's glass/lens with any product, including but not limited to clear antifouling paints or similar, without consulting OceanLED for advice. Failure to do so will void your warranty. Do not use any un-authorized cleaning products to remove excess paint or antifoul off the glass or within 5mm of the glass. OceanLED recommends using Isopropyl Alcohol (IPA) only.

2.3 ESSENTIAL TEST

! Perform this bonding check after installation of the light and before moving the vessel back into the water.

Refer to bonding information in the installation sections in this manual. If in doubt, please contact OceanLED.

1. Connect the light assembly to the cathodic protection system as explained in section 2.1.
2. Measure the electrical continuity between the Pro-Series to Explore Front Plate (not the Explore XFM light front bezel) and the sacrificial anode. This test should give a reading of up to 0.5 Ω (Ohms). This procedure ensures proper electrical continuity between the Pro-Series to Explore Front Plate, the mounting tube, and the sacrificial anode.

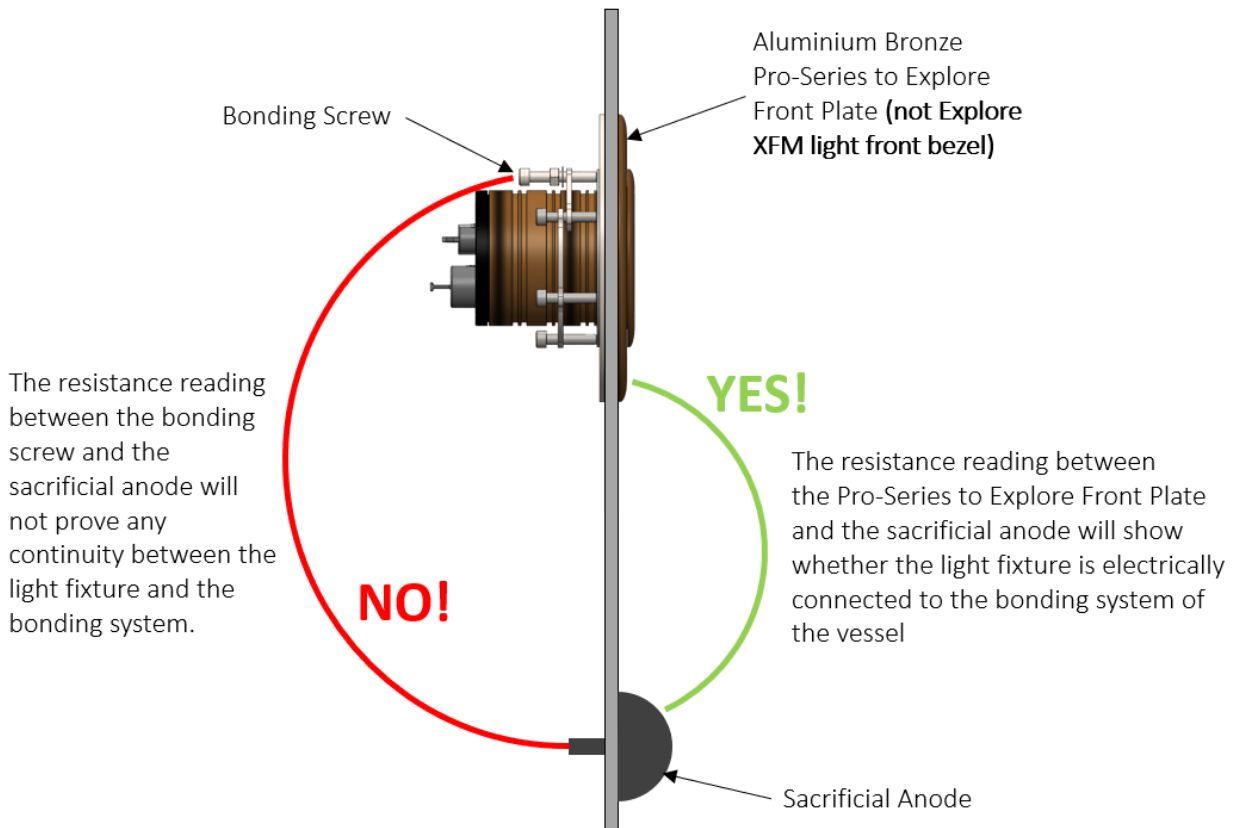

If you have any questions regarding the above, please contact OceanLED:

+44 (0) 1455 637505 or info@oceanled.com

3 Appendix

3.1 OVERALL DIMENSIONS

Pro-Series to Explore Upgrade Kit

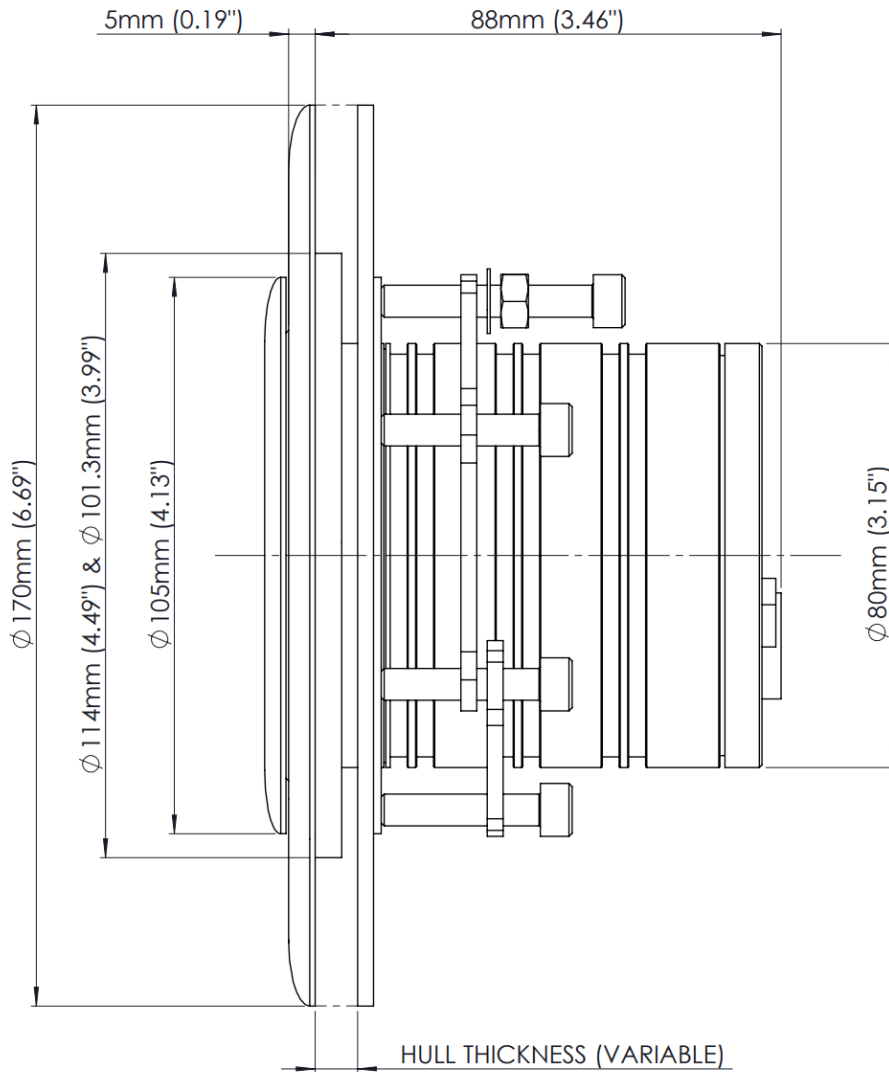

Pro-series to Explore Upgrade Kit
with Explore XFM light.

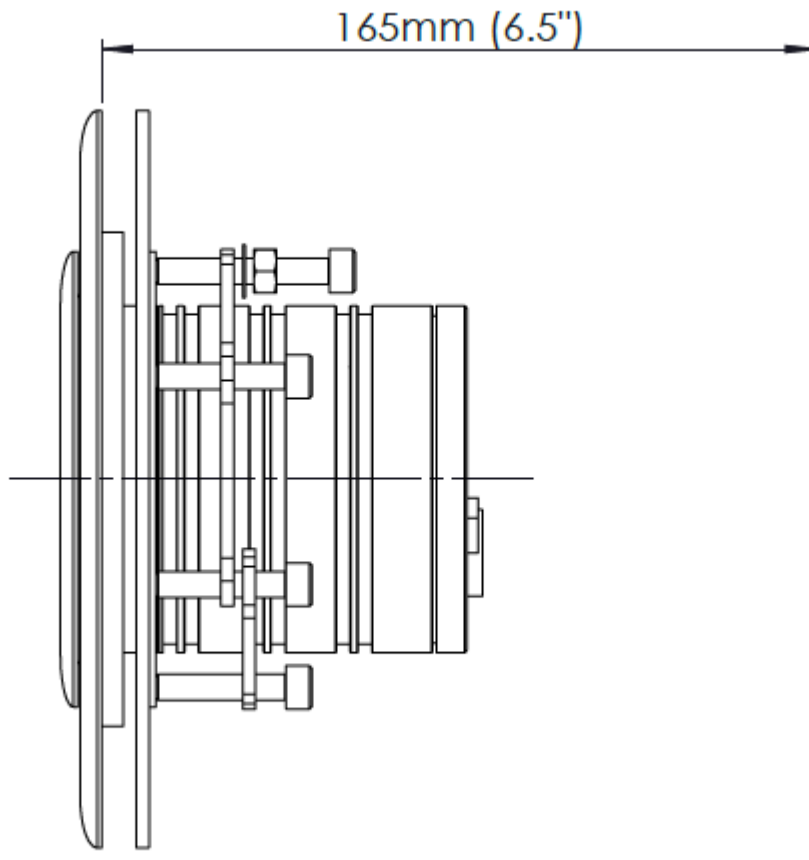

Clearance required to remove the light cartridge 165mm (6.5")

4 Warranty

Please remove this page and keep for your files.

For technical assistance:
Europe: service@oceanled.com
The Americas: warranty@oceanledusa.com

Warranty Serial Code(s):

© 2026 Ocean LED Marine LTD
All Rights Reserved

Specifications are subject to
change without notice.

Trademarks are the property of
Ocean LED Marine LTD

Ocean LED Marine LTD
Unit 1 Jacknell Road
Dodwells Bridge Industrial
Estate Hinckley,
Leicestershire LE10 3BS
United Kingdom

Tel: +44 (0) 1455 637505
Fax: +44 (0) 1455 238553
sales@oceanled.com

Ocean LED USA LLC
778 South Military Trail
Deerfield Beach
Florida
FL 33442-3025
USA

Tel: +1 954.523.2250
Fax: +1 954.523.2249
sales@oceanledusa.com

www.oceanled.com