

EYES Superyacht Camera

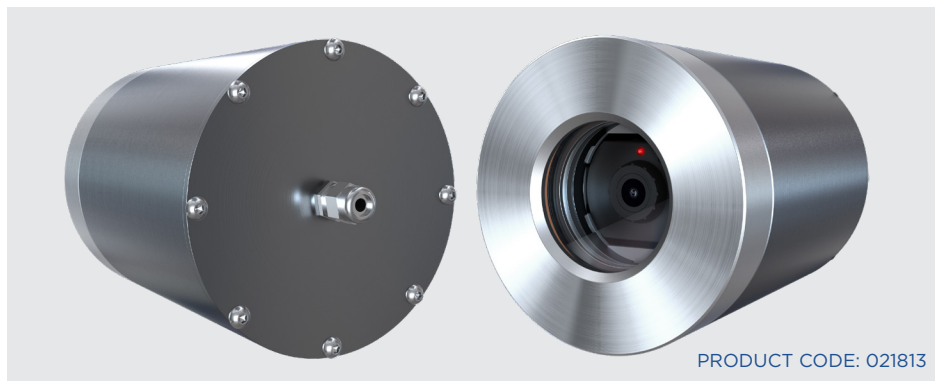

ULTRA HD UNDERWATER CAMERA



PRODUCT CODE: 021813



Ultra Low
Light Vision



4K Ultra
High
Definition



IP PoE
Output



Ultra Wide
Field of View



Vertical
Angling



9.2
Megapixel

The EYES Superyacht Camera is the ultimate accessory for any metal hull superyacht. Designed exclusively for superyachts, this weld-in camera offers never-before-seen immersion into a world below the waves. The EYES Superyacht Camera is a powerhouse of visual opportunity, with a 1/1.8" 4K sensor and 9.2 million pixels, offering 4K visuals of a vast area around the yacht. Compact, durable and ready for anything, the EYES Superyacht Camera is ideal for anything from checking props, monitoring for underwater hazards or just enjoying the marine life.

SEE EVERYTHING BENEATH THE WATERLINE IN VIVID DETAIL

Incorporating a 1/1.8" 4K sensor with over 9 million pixels delivers unparalleled clarity and performance, even in challenging light conditions. Starting at a 100° angle-of-view the EYES Superyacht Camera delivers an ultra-wide perspective with no curvature or distortion. Ideal for use while getting close to shore, looking for underwater hazards, whilst visiting your favourite islands, or simply enjoying the marine life, the ultra HD underwater camera offers a crystal clear picture.

DURABLE, FLEXIBLE, POWERFUL

The EYES Superyacht Camera is suitable for any metal hull yacht. Flush-mounted, compact, and durable, the underwater camera can be installed in almost any part of the hull. Its impressive low-light range capability makes it ideal for use in even semi-darkness, where a visual of the environment below the water line around the yacht is important. The clever design of the EYES Superyacht Camera cofferdam ensures easy serviceability, by making sure the internals can be quickly removed whilst the boat is in the water.

VIEW YOUR CAMERA FROM ANYWHERE ONBOARD

The advanced IP connectivity of the EYES Superyacht Camera makes it possible to view your underwater camera feed from anywhere on the yacht. Any smartphone, tablet or computer connected to the Wi-Fi network can log in to the secure visual feed. Ideal for guests wishing to immerse themselves in the world beneath the waves and for crew, making it easy to view what's happening from anywhere on the vessel. The advanced connectivity also serves to enhance security capabilities onboard, offering 24/7 coverage of the immediate underwater area around the vessel.

UNRIVALLED QUALITY

At OceanLED we understand quality and reliability are paramount for our customers, especially when equipment is being specified for use on superyachts. The EYES Superyacht Camera is built to the same rigorous standards as our superyacht underwater light range. Boasting an IP69K water intrusion certification, the robust stainless steel or aluminium cofferdam incorporates the unique dual-seal lens design from our E8 and E9 underwater lights. Making the EYES Superyacht Camera the most durable superyacht-specific camera on the market.

SEAMLESS INTEGRATION

The EYES Superyacht Camera has been designed to seamlessly integrate with any yacht with a metal hull and its onboard equipment. Installation is easy, with the cofferdam welded into the hull during build. For vessels with older OceanLED lights (F-Series), an upgrade path is available for retrofitting the EYES Superyacht Camera

without the need to cut out and reweld a new cofferdam. Easy integration is further assured with the use of a single line-in ethernet connection, meaning wiring can be easily added to existing pathways.

TECHNICAL INFORMATION:

SENSOR			
Image Sensor	1/1.8" 4K - 9.2 Million Pixels	Min Illumination	Low Light sensitivity (0.05 Lux)
Effective Pixels	3840(H) x 2160P(P) 4K at 60fps	Horizontal Resolution	3840(H)
OPTICS			
Focal Length	4.57mm typical	Focus	Manual
Zoom	+ 12x clear digital zoom	Horizontal Angle of View	102°(Horizontal)
FUNCTIONS			
Back Light Compensation	WD WDR/BLC, HLC (High Light Compensation)	White Balance	Auto, manual
Exposure	Auto, Manual	Electronic Shutter	1-1/10,000 sec
Physical			
Power Consumption	12W via PoE, and 10W via DC (12V)	Environmental Operating	0°C ~ 40°C
Angling	+/- 15° Vertical Angling	Connection	POE IP68
Control Interface	Ethernet	Control Protocol	VISCA over IP/ ONVIF/ UVC
Connectivity	300mm Ethernet cable, IP68 female to female connector	Dimensions	Width: 150mm Height: 150mm Length: 160mm
APPROVALS & WARRANTY			
Lloyds Register		Warranty	3 Years

BOX CONTENTS:

- EYES Underwater Camera
- Rear Cofferdam
- Lid Assembly
- Camera Bracket
- Loose Fittings & Seals

ACCESSORIES:

REQUIRED WITH YOUR ORDER	
Item	Part
First Seal Kit	023124
E8 Stainless Steel Cofferdam	021128
E8 Aluminium Cofferdam	021129

OPTIONAL	
Item	Part
E8 Welding Jig	023128

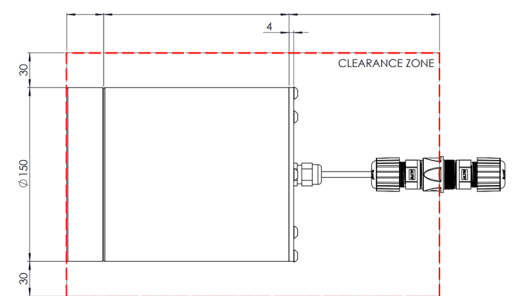

IMPORTANT NOTES:

Maintenance - Use a sponge or nylon brush with soap and water to clean your camera. A flexible straightedge may be used to remove growth on the lens or bezel if required. Do not use a jet wash on your lights.

Installation - All information provided in the installation manual represent normal installation instruction and is provided as guidance only. Please contact OceanLED for advice if you wish to install outside these parameters.

Disclaimer - OceanLED has taken care to ensure that the information provided in the literature is correct and up to date. However, it is not intended to form any part of a contract or provide a guarantee. Purchasers/ intending purchasers should contact OceanLED to check whether there have been any changes to the information since the publication of the literature. **Please ensure you have read the full installation guide before fitting this product.**

INSTALLATION (QUICK START GUIDE):

1. Check Explore E8 cofferdam prior to installation to ensure it is fit for use.
2. Ensure the arrow on the back of the cofferdam points upwards.
3. Care should be taken whilst welding-in the cofferdam to prevent damage or warping. (Blanking plates are available to protect the sealing surfaces.)
4. After weld, fit the E8 lens, compensation ring, small O-ring, large O-ring & retaining ring.

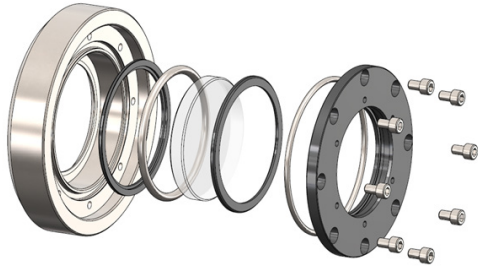

5. MECHANICAL INSTALLATION:

Overview

Test the camera before fitting to ensure full functionality.

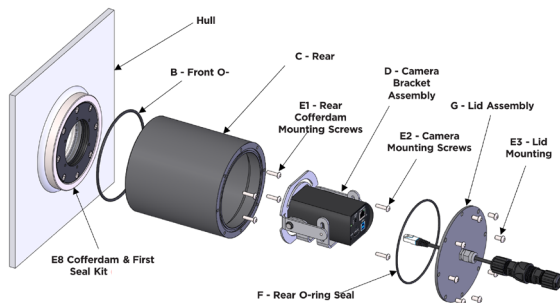

6. Place the front O-ring in the outer groove on the front face of the rear cofferdam.

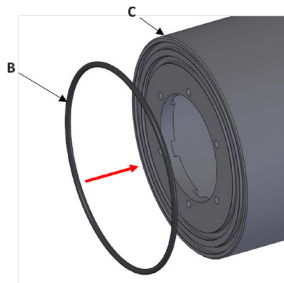

7. Align rear cofferdam with E8 cofferdam & secure with the four screws provided.

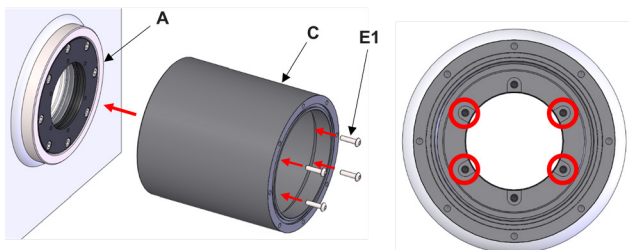

8. Insert camera bracket assembly into the rear cofferdam. Secure with the two mounting screws provided. Rotate camera to the UP orientation before tightening down.

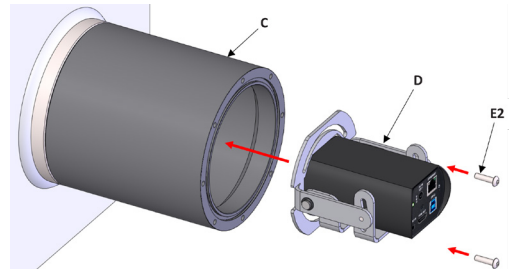

ADJUSTING CAMERA POSITION:

9. Camera Angling

With the camera bracket now fitted, set the vertical angling.

Use an 8mm spanner to slightly loosen the two M5 screws on the back of the Camera Bracket Assembly. Rotate the camera upwards or downwards ($\pm 15^\circ$ max.) to the desired viewing angle.

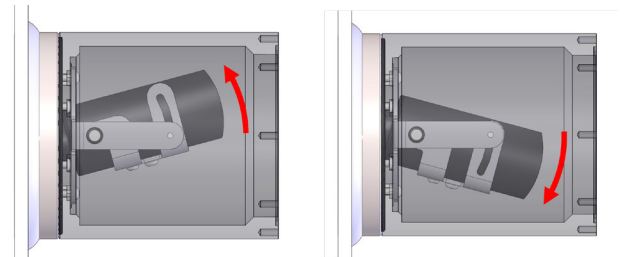

SEALING

10. Final Assembly

Position the rear O-ring seal inside the groove on the rear face of the rear cofferdam.

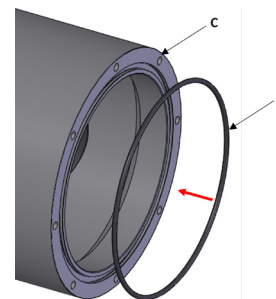

11. Connect ethernet connector & lid assembly. Secure with the eight screws provided.

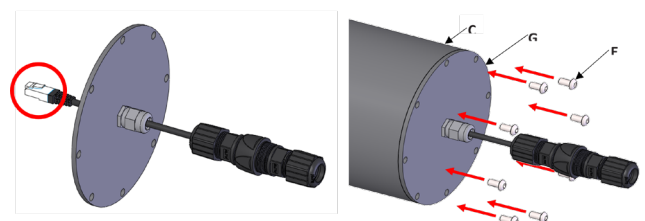

FOR FULL INSTALLATION INSTRUCTIONS, SEE THE INSTALLATION MANUAL.

SUSTAINABILITY

OceanLED is committed to a sustainable future. Through constant product and design innovation, establishing better working practices, and evaluating our supply chains, we are able to take measurable steps to creating true sustainability in our business.